

ETU-LINK

OUR CONTINUAL PURSUIT IS TO WIN YOUR MOVING



ETU-LINK TECHNOLOGY CO., LTD.



- 📍 Factory: Right side of the third floor of Baichuanda Industrial Park, Longguan Expressway, Longhua New District, Shenzhen
- 📍 Office: Floor 4, Building 4, Nanshan Yungu Phase II, Taoyuan Community, Xili Street, Nanshan District, Shenzhen
- ☎ +86-755 2328 4603
- ✉ sales@etulinktechnology.com
- 🌐 www.etulinktechnology.com

2024





Do you know
ETU LINK?



Do you know our team?

Factory: Right side of the third floor of
Baichuanda Industrial Park, Longguan Expressway,
Longhua New District, Shenzhen



Office: Floor 4, Building 4, Nanshan Yungu
Phase II, Taoyuan Community, Xili Street, Nanshan
District, Shenzhen

Who We Are?

ETU-Link Technology Co., LTD(ETU-LINK) focus on the development, application and promotion of new technologies and new products. We currently have a full range of optical modules, high-speed AOC/DAC cable production lines and optical network supporting products, which are widely used in Ethernet, Infiniband, FTTH, SDH, SONET, data center and other communication fields.

Advanced technology

Deeply plowing the optical communication industry for more than ten years, and obtaining the certification of «Specializing in New SMEs»and «National High-tech Enterprises», and possessing more than 50 patents

Efficient production

The advanced production line ensures efficient and standardized production, with a timely delivery rate of more than 99% and stable production capacity. A senior technical team with an average of more than 15 years of experience in the industry provides escort.

Excellent quality

Through ISO9001 quality system certification and CE, ROHS, FCC, SGS, TUV, CB and other international certifications, the product quality has reached the first-class level in the industry.

Globally recognized

The products are sold to more than 100 countries all over the world, and the same customer repurchased up to 568 times, winning extensive trust.

Innovation leading

Adhering to customer demand-oriented, quality as life, innovation as power, we are committed to become a leader in the field of global optical communications. We look forward to establishing long-term and stable cooperation with more customers and jointly promoting the development and application of optical communication technology.



Let's see the factory



▲ Production Department 1



Production Department 2 ▲

Do you want to see Where we go?

ECOC 2017
Sweden Gothenburg



Convergence 2017
India Delhi



2022 CIOE

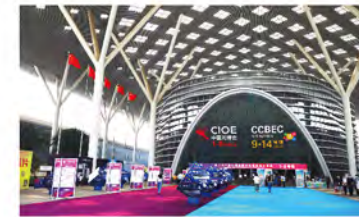

2023

SVIAZ 2019
Russia Moscow

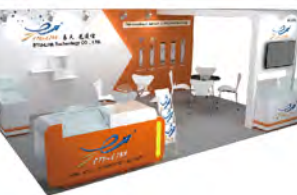

CommunicAsia 2019
Singapore

2022

2023 CIOE



2023 ECOC

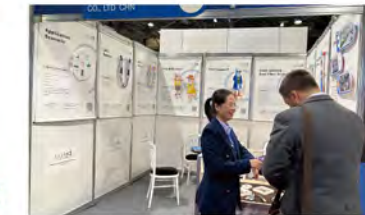

2023 Viet Nam ICT COMM

Do you worry about The quality?

Certification



Patent



Contents

400G Transceiver	P22
400G QSFP-DD	
400G OSFP	
200G Transceiver	P23
200G QSFP56	
100G Transceiver	P24~25
100G QSFP28 Dual Fiber	
100G QSFP28 Single Fiber	
40G QSFP+ Transceiver	P26
40G QSFP+ Dual Fiber	
40G QSFP+ Single Fiber	
25G SFP28 Transceiver	P27~28
25G SFP28 Dual Fiber	
25G SFP28 Single Fiber	
Active Optical Cable	P29~35
400G QSFP-DD AOC Cable	
200G QSFP56 AOC Cable	
100G QSFP28 AOC Cable	
40G QSFP+ AOC Cable	
25G SFP28 AOC Cable	
10G SFP+ AOC Cable	
Direct Attach Cable	P36~43
800G OSFP DAC Cable	
400G QSFP-DD DAC Cable	
200G QSFP56 DAC Cable	
100G QSFP28 DAC Cable	
56G QSFP+ DAC Cable	
40G QSFP+ DAC Cable	
25G SFP28 DAC Cable	
10G SFP+ DAC Cable	
10G XFP Transceiver	P44
10G XFP Single Fiber	
10G XFP Dual Fiber	
10G XFP CWDM/DWDM	

10G SFP+ Transceiver	P45~49
10G SFP+ Single Fiber	
10G SFP+ Dual Fiber	
10G SFP+ CWDM/DWDM	
8G SFP+ Dual Fiber	
SFP Copper Transceiver	
Converter	P50
QSFP28 TO SFP28 Converter	
QSFP+ TO SFP+ Converter	
SFP Transceiver	P51~58
2.5G SFP Single Fiber	
2.5G SFP Dual Fiber	
1.25G SFP Single Fiber	
1.25G SFP Dual Fiber	
1.25G/2.5G SFP CWDM	
155M SFP Single Fiber	
155M SFP Dual Fiber	
EPON/GPON Transceiver	P59
EPON OLT PX20+	
EPON OLT PX20++	
EPON OLT PX20+++Enhanced	
GPON OLT B+	
GPON OLT C+	
GPON OLT C++Enhanced	
Optical Components	P60~63
Coding Tool	
Patch Cord Details	
Pigtail Details	
Adapter Details	
Media Converter	P64~66
10G SFP Media Converter	
10/100M Media Converter	
1000M Media Converter	
10/100/1000M Media Converter	

The Naming Rule

ETU-LINK Product Model Naming Rule

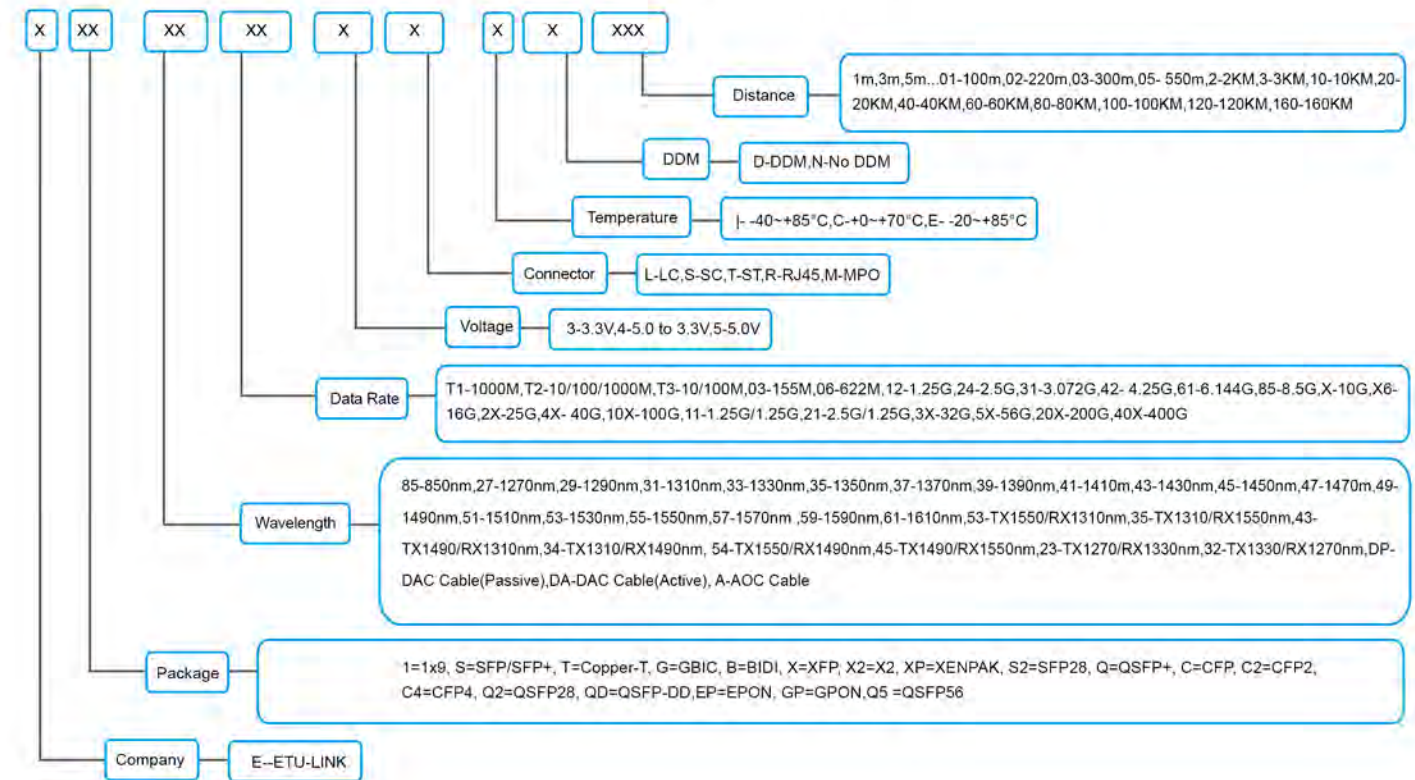

For Example: EQ23110X-3LCD80

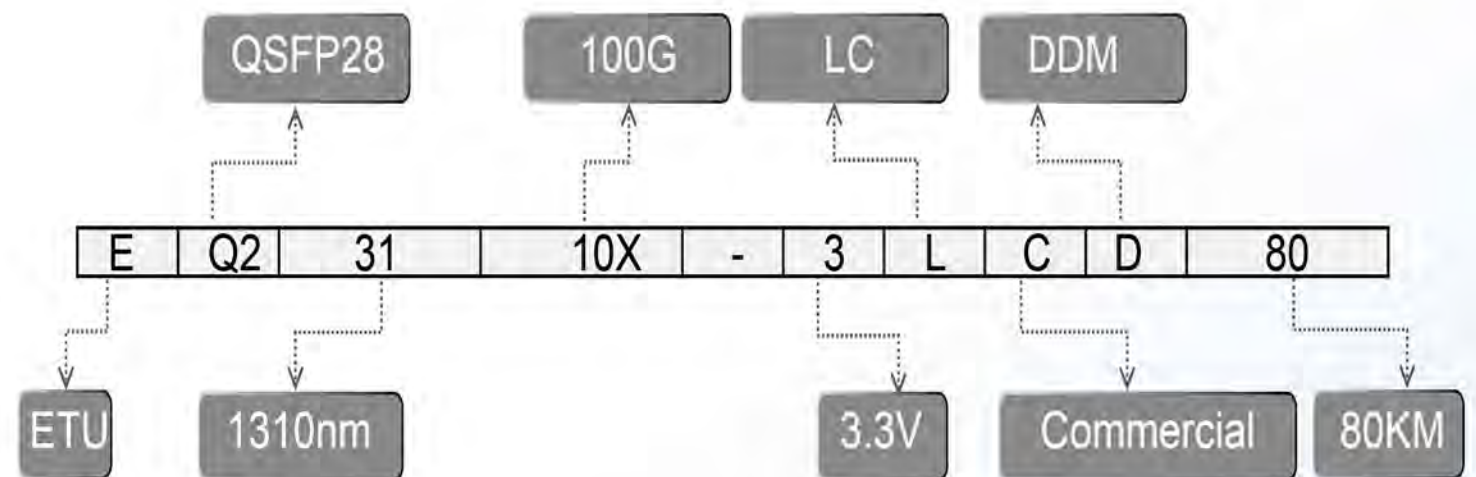

The Installation Guide

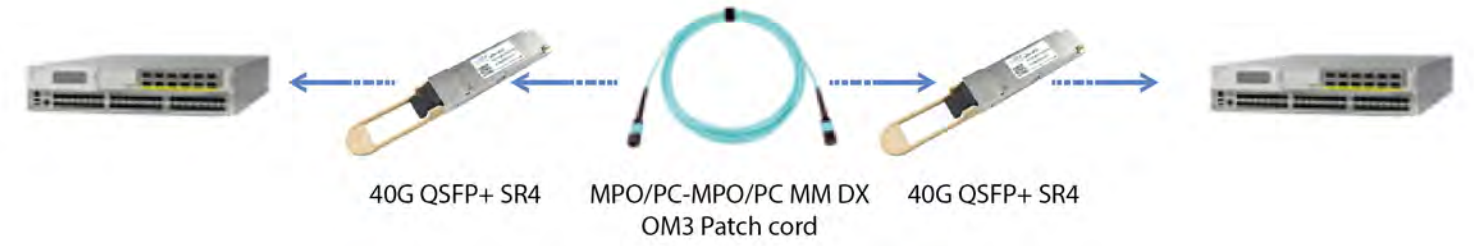

Notes: If the module is not matched with th patch cord properly, the product will not working.

Products Processing

The Flow of Laser Production



01 Metal Device Cleaning



02 Assembling



03 Laser Spot Welding



04 Emission Coupling



05 End Face Cleaning



06 Initial Launch Testing



07 Power Control



08 Reception Coupling



09 Viscose Baking



10 Warm Evidence-based

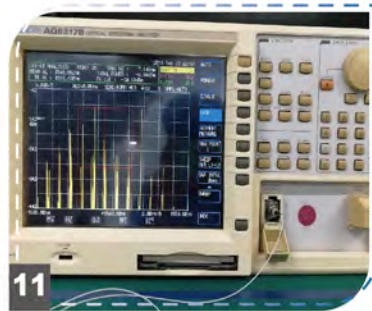

11 Spectral Testing



12 Packaging

The Production Processing of SFP



01 Firmware program download



02 weld assembly TOSA. ROSA



03 PCBA cleaning & inspection

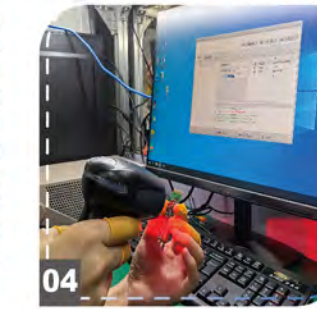

04 Serial number pairing



05 Assemble



06 Module temperature cycle



07 Module debugging



08 Power-on aging



09 Check and clean module optical end face



10 Low temperature test



11 High temperature test



12 Normal temperature test



13 Check and clean module optical end face



14 Write the code and label

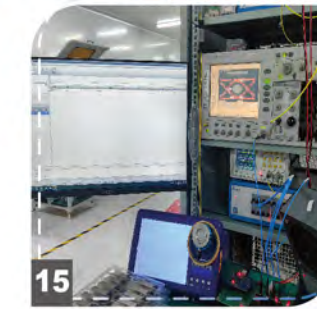

15 EEPROM CHECK



16 Module appearance cleaning & inspection



17 OQC sampling



18 Package process

Mounting and Dismounting of Optical Modules

01 Mounting

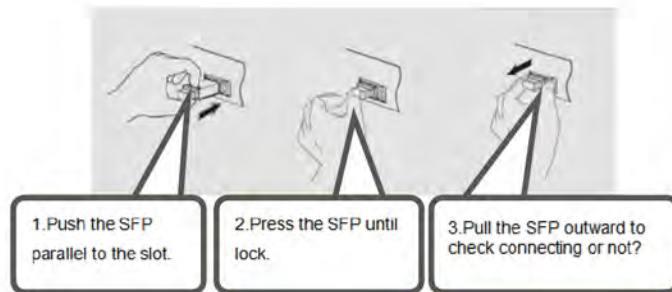

02 Dismounting

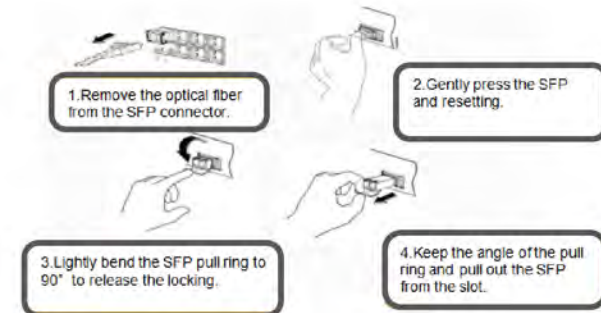

Product Comparison

Single Fiber VS Dual Fiber Media Converter

Advantage: Effectively control the fiber cost.



Single Fiber Media Converter A + SC/UPC-SC/UPC SM SX Patch Cord + Single Fiber Media Converter B

Advantage: Dual core fiber, it will be no worried when one of them meet problem.



Dual Fiber Media Converter + SC/UPC-SC/UPC SM DX Patch Cord + Dual Fiber Media Converter

Fault Analysis and Solution

Phenomenon	Preliminary Analysis	Investigation	Solution
Indicator light no lighting	Compatibility	<ul style="list-style-type: none"> ※ Checking the Tx port by optical power meter if has Tx power. ※ Input device command to check if the DDM can be read. 	<ul style="list-style-type: none"> ※ There is no optical power output and the DDM information invalid, check with the vendor if write the right code for device.
Tx power normally working, no communication	Optical path break down	<ul style="list-style-type: none"> ※ Check the fiber connected correctly or not? ※ Check whether the optical fiber section/ SFP port is polluted or not? Polluted fiber section/ SFP 	<ul style="list-style-type: none"> ※ Correct the right connection way. ※ Clean the patch cord with dust-free paper or use the cleaner to clean the SFP port.
Link down	Matching faulty	<ul style="list-style-type: none"> ※ Check the optical module if mach the switch port, such as data rata, distance, and singe fiber SFP/ dual fiber SFP. 	<ul style="list-style-type: none"> ※ Replace the suitable optical module.

Single Fiber VS Dual Fiber SFP

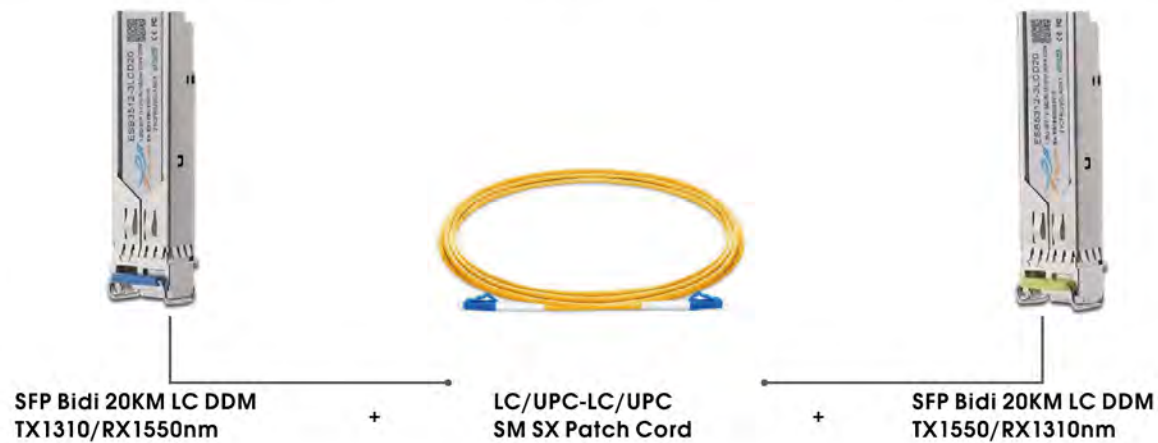
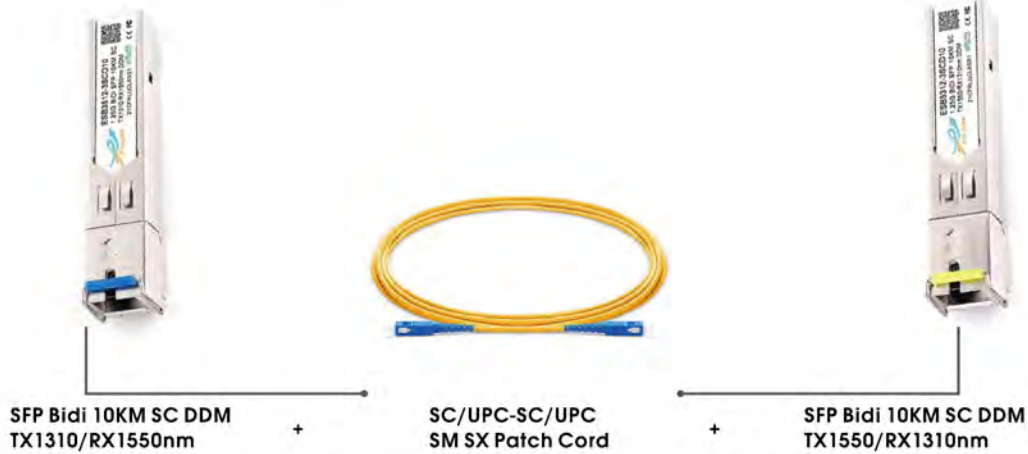

Single Mode VS Multimode SFP

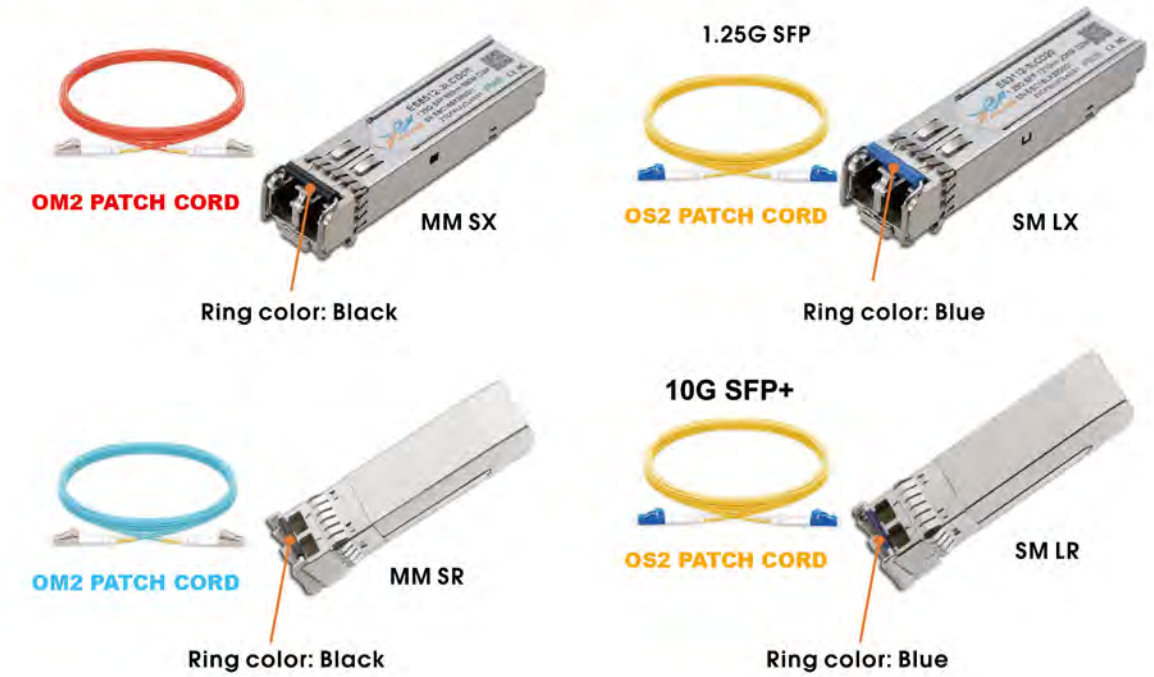

Tips:
 The fiber need to match the corresponding SFP, or else it will be no working.
 Single mode SFP matches with single mode patch cord;
 Multi mode SFP matches with multi mode patch cord.

100G QSFP28+ Modules VS DAC/AOC Cable



① DAC/AOC installation is more convenient than QSFP+ modules with patch cord.
 ② Compare with QSFP modules, DAC/AOC occupy absolute cost advantage.

Package

Individual SFP



Individual QSFP

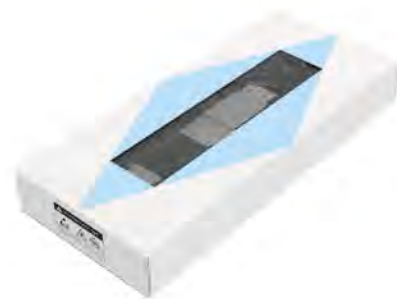

4PCS/Tray



10PCS/Tray



Product List 400G Transceiver



Features

- Compliant with IEEE802.3bs standard: 400GAUI-8 electrical interface
- Compliant with IEEE 802.3bs standard:
- Case operating temperature 0°C to 70°C
- RoHS compliant
- Class 1 Laser

Product Information

Model No.	Data Rate	Package	Wavelength(nm)	Distance	Output Power	Temp.(°C)	Sensitivity	Interface	Source
EOP400-SR4	400G	SR4 OSFP	850nm	100M	-4.6~4	0~70	-4.6	MPO	VCSEL+PIN
EQD400-SR4	400G	SR4 QSFP-DD	850nm	100M	-4.6~4	0~70	-4.6	MPO	VCSEL+PIN
EQD400-SR8	400G	SR8 QSFP-DD	850nm	100M	-8.4~4	0~70	-3.4	MPO16	VCSEL+PIN
EQD400-DR4	400G	DR4 QSFP-DD	1310nm	500	-2.9~4	0~70	-4.4	MTP/MPO-12	EML+PIN
EQD400-LR4	400G	LR4 QSFP-DD	1310nm	10KM	-2.7~5.1	0~70	-4.3	LC	ENL CWDM +PIN
EQD400-FR4	400G	FR4 QSFP-DD	1310nm	2KM	-3.3~3.5	0~70	-2.6	LC	ENL CWDM +PIN
EQD400-LR8	400G	LR8 QSFP-DD	1310nm	10KM	-2.8~5.3	0~70	-7.1	LC	EML+PIN
EQD400-ER8	400G	ER8 QSFP-DD	1310nm	40KM	-0.6~5.6	0~70	-14	LC	EML+APD

Applications 1:



Cisco Nexus 9364D-GX2A



Cisco Nexus 9364D-GX2A



400G DR4 1310nm 500M



MPO-MPO Female



400G DR4 1310nm 500M

Item No	ETU PN	Description
01	EQD3140X-3MCD05	400G DR4 1310nm 500M DDM
02	Patch cord	MPO-MPO Female OS2 TypeB 12core

200G Transceiver



Features

- Compliant with 200G-SR4/SR8/ optical specifications
- 4x53.125Gb/s electrical interface (200GAUI-4)
- Single +3.3V power supply
- Case temperature range: 0 ~ +70 C
- RoHS complain



Product Information

Model No.	Data Rate	Package	Wavelength(nm)	Distance	Output Power	Temp.(°C)	Sensitivity	Interface	Source
EQP200-SR4	200G	SR4 QSFP56	850nm	100M	-6.5~4	0~70	-3.4	MPO	VCSEL+PIN
EQD200-SR8	200G	SR8 QSFPDD	850nm	100M	-6.5~4	0~70	-5.2	MPO	VCSEL+PIN
EQP200-FR4	200G	FR4 QSFP56	1270-1330nm	2KM	-4.2~4.7	0~70	-6	LC	EML+PIN
EQP200-ER4	200G	ER4 QSFP56	1310nm	40KM	0.4~6.6	0~70	-16.5	LC	DFB+APD

Product List 100G QSFP28 Transceiver



Features

- Digital diagnostics monitoring interface
- Duplex LC optical receptacle
- No external reference clock
- Single 3.3 V power supply
- Case operating temperature range:0°C to 70°C



Product Information

Model No.	Data Rate	Package	Wavelength(nm)	Distance	Output Power	Temp.(°C)	Sensitivity	Interface	Source
EQ28510X-3MCD01	100G	QSFP28 SR4	850nm	100m	-8.4~2.4	0~70	-12	MPO	VCSEL+PIN
EQ23110X-3MCD2	100G	QSFP28 IR4	1310nm	2km	-6~2	0~70	-11.35	MPO	PSM4 DFB+PIN
EQ23110X-3LCD2	100G	QSFP28 CLR4	1295.56-1309.14nm	2km	-6.5~2.5	0~70	-10	LC	DFB+PIN
EQ2xx10X-3LCD2	100G	QSFP28	1270-1330nm	2km	-4~2.5	0~70	-10	LC	CWDM4 1270-1330nm
EQ2xx10X-3LCD10	100G	QSFP28	1270-1330nm	10km	-4~2.5	0~70	-11.5	LC	CWDM4 1270-1330nm
EQ23110X-3LCD10	100G	QSFP28 LR4	1295.56-1309.14nm	10km	-4.3~4.5	0~70	-8.6	LC	DFB+PIN
EQ23110X-3LCD30	100G	QSFP28 ER4	1295.56-1309.14nm	30km	-1.9~4.5	0~70	-16.45	LC	DML+APD
EQ23110X-3LCD40	100G	QSFP28 ER4	1295.56-1309.14nm	40km	-2.9~4.5	0~70	-18.65	LC	DML+APD
EQ2S3110X-3LCD10	100G	QSFP28 LR1	1310nm	10km	-1.4~4.5	0~70	-6.1	LC	EML+PIN
EQ2S3110X-3LCD30	100G	QSFP28 ER1	1310nm	30km	0~5.6	0~70	-12.5	LC	EML+APD
EQ2M3110X-3LCD40	100G	QSFP28 ER4	1295.56-1309.14nm	40km	-2.9~4.5	0~70	-18.65	LC	DML+APD
EQ23110X-3LCD60	100G	QSFP28 ZR4	1295.56-1309.14nm	60km	2~4.5	0~70	-25.5	LC	EML+APD
EQ23110X-3LCD80	100G	QSFP28 ZR4	1295.56-1309.14nm	80km	1~6.5	0~70	-28	LC	EML+PIN
EQ23110X-3LCD100	100G	QSFP28 ZR4	1295.56-1309.14nm	100km	3~6.5	0~70	-30	LC	EML+PIN
EQ28510X-3LCD01	100G	QSFP28 SWDM4	850-940nm	150m	-9.5~3.4	0~70	-8.8	LC	VCSEL+PIN

100G QSFP28 BIDI Transceiver



Features

- Hot-pluggable QSFP28 form factor
- Support Ethernet CAUI-4
- Support OTU4
- High Sensitivity PD Receiver
- Operation case temperature C/E/I-Temp
- Single 3.3V power supply
- Aligned with IEEE 802.3bs and 100G Lambda MSA
- Simplex LC receptacles
- I2C management interface
- RoHS-6 compliant
- 4X28G serial Interface(CEI-28G-VSR)

Product Information

Model No.	Data Rate	Package	Wavelength(nm)	Distance	Output Power	Temp.(°C)	Sensitivity	Interface	Source
EB89Y-01D	100G	QSFP28 Bidi SR4	850nm	100m	-6.2~4	0~70	-8	LC	VCSEL+PIN
★ EB23Y-10D	100G	QSFP28	1270/1330nm	10KM	-6.2~4	0~70	-8	LC	EML +PIN
★ EB32Y-10D	100G	QSFP28	1270/1330nm	10KM		0~70		LC	EML +PIN
EB91Y-20D	100G	QSFP28	1291/1311nm	20KM	-1.4~4.5	0~70	-6.1	LC	EML +PIN
EB19Y-20D	100G	QSFP28	1311/1291nm	20KM		0~70		LC	EML +PIN
EB59Y-30D	100G	QSFP28	1304/1309nm	30KM	-0.2~6.6	0~70	-5.4	LC	EML +APD
EB95Y-30D	100G	QSFP28	1309/1304nm	30KM		0~70		LC	EML +APD
EB59Y-40D	100G	QSFP28	1304/1309nm	40KM	0~5.6	0~70	-12.5	LC	EML +APD
EB95Y-40D	100G	QSFP28	1309/1304nm	40KM		0~70		LC	EML +APD

Applications 2:

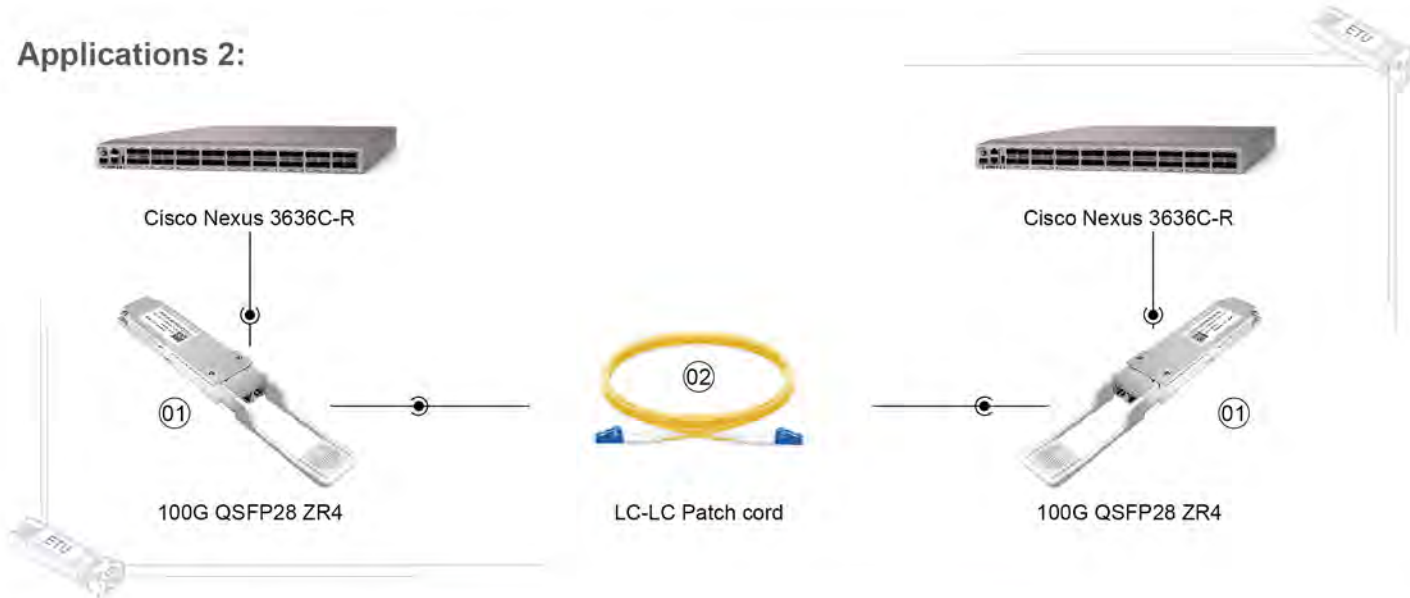

Item No	ETU PN	Description
01	EQ23110X-3LCD80	100G QSFP28 ZR4 1310nm 80KM LC DDM
02	Patch cord	LC/UPC-LC/UPC SM DX OS2

40G QSFP+ Transceiver



Features

- Hot-pluggable QSFP form factor
- Supports 41.2Gb/s aggregate bit rates
- Power dissipation < 3.5W
- Commercial case temperature range 0°C to 70°C
- Single 3.3V power supply
- XLPPI electrical interface
- Built-in digital diagnostic monitoring functions, including Tx/Rx power

Product Information

Model No.	Data Rate	Package	Abbreviation	Wavelength(nm)	Distance	Output Power	Temp.(°C)	Sensitivity	Interface	Source
EQ854X-3MCD01	40G	QSFP+	SR4	850	100M	-7.6~0.5	0~70	<-9.5	MPO	VCSEL+PIN
EQ854X-3MCD03	40G	QSFP+	ESR4	850	300M	-7.6~1	0~70	<-9.9	MPO	VCSEL+PIN
EQ314X-3MCD2	40G	QSFP+	IR4	1310	2KM	-7.6~1	0~70	<-9.9	MPO	DFB+PIN
EQ314X-3LCD2	40G	QSFP+	LX4	4*10 CWDM	2KM	-7~2.3	0~70	<-11.5	LC	DFB+PIN
EQxx4X-3LCD10	40G	QSFP+	LR4	4*10 CWDM	10KM	-7~2.3	0~70	<-11.5	LC	DFB+PIN
EQ314X-3MCD10	40G	QSFP+	LR4	1310	10KM	-5.5~1.5	0~70	<-12.5	MPO	DFB+PIN
EQxx4X-3LCD30	40G	QSFP+	Lite ER4	CWDM	30KM	-7~2.3	0~70	<-11.5	LC	DFB+PIN
EQxx4X-3LCD40	40G	QSFP+	ER4	CWDM	40KM	-2.7~4.5	0~70	<-16.8	LC	DFB+PIN
EQB854X-3LCD01	40G	QSFP+ Bidi	SR4-BD	850	150M	-4~5	0~70	<-11	LC	VCSEL+PIN
EQ314X-3MCD10	40G	QSFP+	PSM LR4	1310	10KM	-5.5~1.5	0~70	<-12.5	MPO	DFB+PIN
EQ314X-3LCD40	40G	QSFP+	ER4	1310	40KM	-2.7~4.5	0~70	<-16.8	LC	DFB+PIN
EQxx4X-3LCD80	40G	QSFP+	ZR4	1310	80KM	+4~7	0~70	<-6	LC	DFB+APD
EQ854X-3LCD02	40G	QSFP+	SWDM4	850-940	240m	-7.5~3	0~70	-9.1	LC	VCSEL+PIN

Applications 3:

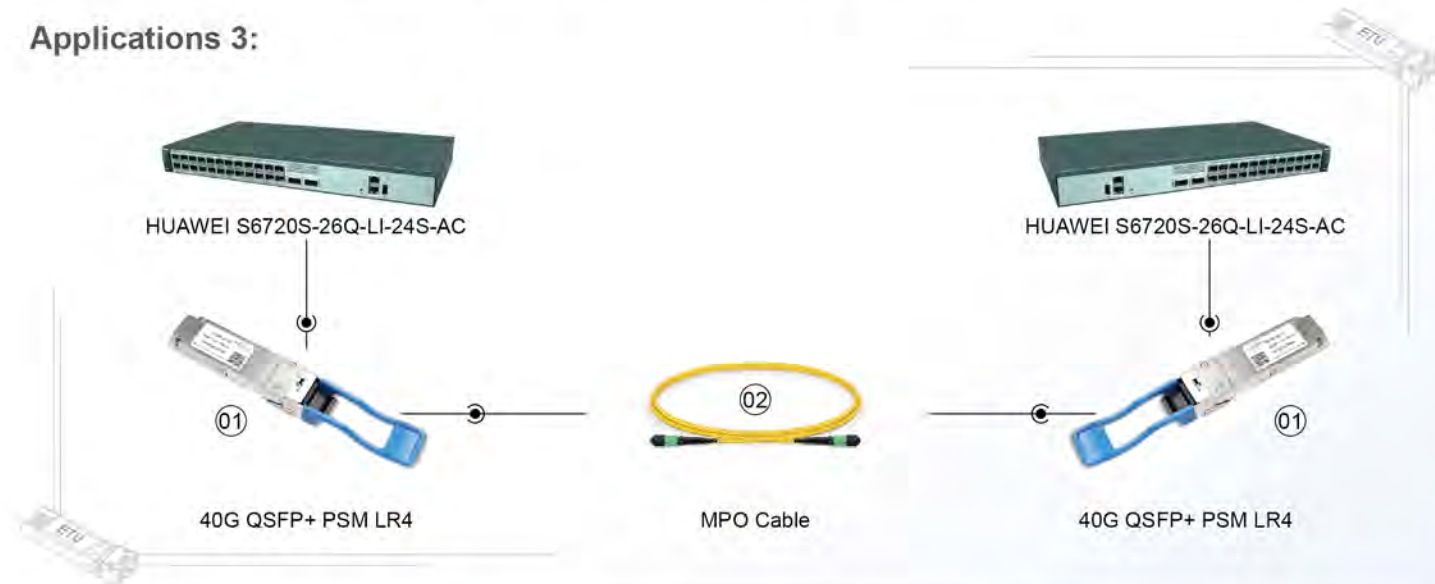

Item No	ETU PN	Description
01	EQ314X-3MCD10	40G QSFP+ PSM LR4 1310nm 10KM MPO
02	MPO Cable	SM 12core MPO/APC MPO/APC Female 3.0mm LSZH type B

25G SFP28 Transceiver



Features

- Supports 25Gbps data rate
- Internal CDR on both transmitter and receiver channel
- Hot-pluggable SFP28 form factor
- Duplex LC receptacle
- Single 3.3V power supply
- Digital diagnostics functions are available via the I2C interface
- ROHS 6 compliant
- Case operating temperature range: 0°C to 70°C

Product Information

Model No.	Data Rate	Package	Wavelength(nm)	Distance	Output Power	Temp.(°C)	Sensitivity	Interface	Source
ES2852X-3LCD01	25G	SFP28	850	100M	-8.4~2.4	0~70	-10.3	LC	VCSEL+PIN
ES2312X-3LCD10	25G	SFP28	1310	10KM	-8.4~2.4	0~70	-10.3	LC	DFB+PIN
ES2312X-3LCD20	25G	SFP28	1310	20KM	-6~2	0~70	-13.3	LC	DFB+PIN
ES2312X-3LCD30	25G	SFP28	1310	30KM	-3~6	0~70	-14	LC	DFB+APD
ES2312X-3LCD40	25G	SFP28	1310	40KM	-20~-4	0~70	-14	LC	DFB+APD
ES2312X-3LCD80	25G	SFP28	1310	80KM	2~7	0~70	-28	LC	EML+PIN
ES2Cxx2X-3LCD10	25G	SFP28	CWDM1270-1370	10KM	-7~2	0~70	-13.3	LC	DFB+PIN
ES2Cxx2X-3LCD10	25G	SFP28	CWDM1390-1450	10KM		0~70		LC	DFB+PIN
ES2Cxx2X-3LCD10	25G	SFP28	CWDM1470-1610	10KM		0~70		LC	EML+PIN
ES2Cxx2X-3LCD40	25G	SFP28	CWDM1270-1370	40KM	0~5	0~70	-14	LC	EML+APD
ES2Dxx2X-3LCD10	25G	SFP28	DWDM (C17-61)	10KM	-1~6	0~70	-15	LC	EML+APD
ES2TDxx2X-3LCD15	25G	SFP28	DWDM 1566.31~1528.77nm	15KM	0~5	0~70	-19	LC	MZM+APD

Applications 4:

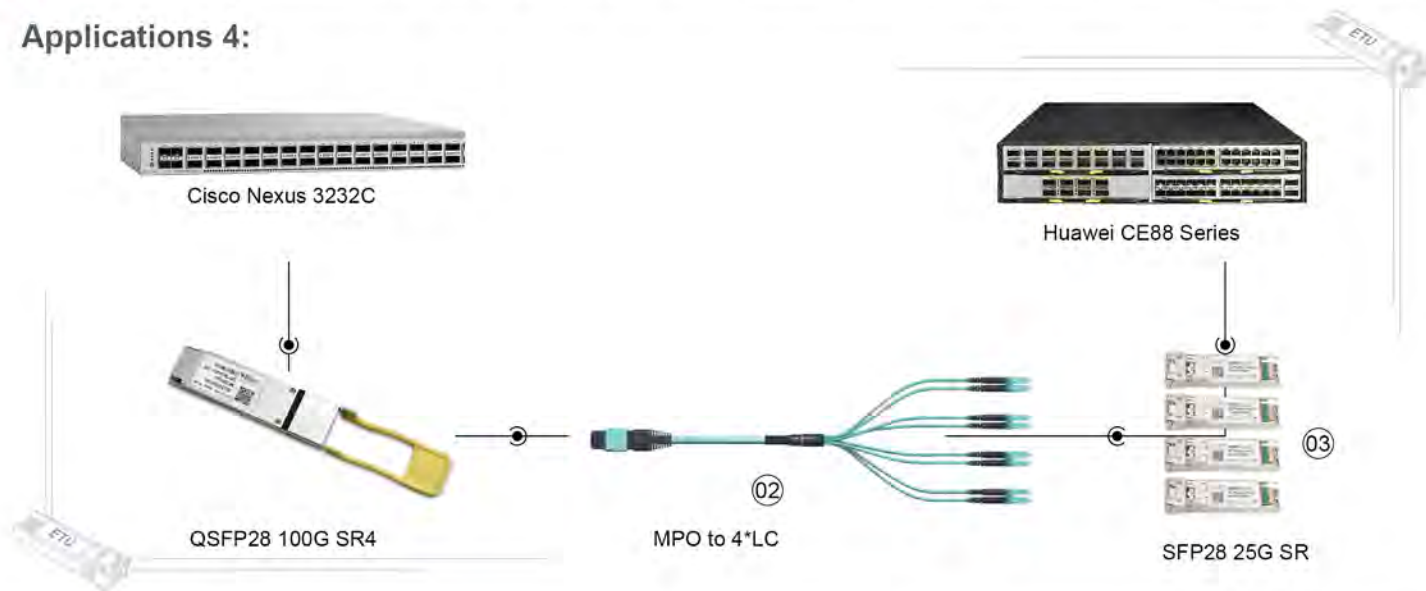

Item No	ETU PN	Description
01	EQ28510X-3MCD01	100G QSFP28 SR4 850nm 100M MPO
02	Patch Cord	1M MPO Female to 4 LC PC Duplex 8 Fibers OM3 Type B
03	ES2852X-3LCD01	25G SFP28 850nm 100M

25G SFP28 Single Fiber



Features

- Supports up to 25.78Gbps bit rates
- Hot-pluggable SFP+ footprint
- Compliant with SFP+ MSA and SFF-8472
- Compatible with RoHS
- Single +3.3V power supply
- Real Time Digital Diagnostic Monitoring

Product Information

Model No.	Data Rate	Package	Wavelength(nm)	Distance	Output Power	Temp.(°C)	Sensitivity	Interface	Source
ES2B232X-3LCD03	25G	SFP28	Tx1270/Rx1330	300M	-4~4	0~70		LC	DML+PIN
ES2B322X-3LCD03	25G	SFP28	Tx1330/Rx1270	300M	-4~4	0~70		LC	DML+PIN
ES2B232X-3LCD10	25G	SFP28	Tx1270/Rx1330	10KM	-7~2	0~70	-13.3	LC	DFB+PIN
ES2B322X-3LCD10	25G	SFP28	Tx1330/Rx1270	10KM	-7~2	0~70	-13.3	LC	DFB+PIN
ES2B232X-3LCD40	25G	SFP28	Tx1270/Rx1330	40KM	-1~6	0~70	-19	LC	DFB+APD
ES2B322X-3LCD40	25G	SFP28	Tx1330/Rx1270	40KM	-1~6	0~70	-19	LC	DFB+APD
ES2B232X-3LCD80	25G	SFP28	TX1295/RX1309	80KM	2~7	0~70	-27	LC	EML+PIN
ES2B322X-3LCD80	25G	SFP28	TX1309/RX1295	80KM	2~7	0~70	-27	LC	EML+PIN

Active Optical Cable

400G QSFP56-DD AOC



Features

- Up to 53.125Gbps data rate per channel by PAM4 modulation
- Support 400GAUI-8 electrical interface
- Integrated 850nm VCSEL array and PD array
- DDM function implemented
- Hot-pluggable QSFP-DD form factor
- Single +3.3V power supply
- Compliant with ROHS2.0

Product Information

PN	Data Rate	Cable Type	Fiber Diameter	Fiber Length
EQDA40X-33CD1	400bps	OM3	3.0mm	1M
EQDA40X-33CD1	400bps	OM3	3.0mm	3M
EQDA40X-33CD2	400bps	OM3	3.0mm	5M
EQDA40X-33CD2	400bps	OM3	3.0mm	7M
EQDA40X-33CD2	400bps	OM3	3.0mm	10M

Note: The cable can be offered different length by customer's request, the longest cable be reached 100M.

200G QSFP56 AOC



Features

- Supports IBTA InfiniBand HDR
- Up to 200Gb/s data rate
- 4x 50Gb/s PAM4 modulation
- SFF-8665 compliant QSFP56 port
- SFF-8636 compliant I2C management
- Single 3.3V power supply
- 4.5W power dissipation each end, with retiming
- Operating case temp Commercial: 0°C to +70 °C
- Hot pluggable
- RoHS compliant

Product Information

PN	Data Rate	Cable Type	Fiber Diameter	Fiber Length
EQ5A20X-33CD1	200Gbps	OM3	3.0mm	1M
EQ5A20X-33CD3	200Gbps	OM3	3.0mm	3M
EQ5A20X-33CD5	200Gbps	OM3	3.0mm	5M
EQ5A20X-33CD7	200Gbps	OM3	3.0mm	7M
EQ5A20X-33CD10	200Gbps	OM3	3.0mm	10M
EQ5A20X-33CD15	200Gbps	OM3	3.0mm	15M
EQ5A20X-33CD20	200Gbps	OM3	3.0mm	20M
EQ5A20X-33CD25	200Gbps	OM3	3.0mm	25M
EQ5A20X-33CD30	200Gbps	OM3	3.0mm	30M

Note: The cable can be offered different length by customer's request, the longest cable be reached 200M.

100G QSFP28 AOC



Features

- Four-channel full-duplex active optical cable
- Reliable VCSEL array technology using multi-mode fiber
- Available in standard lengths of 3, 5, 10, 15, 20, 30, 50, 70m
- Low power consumption <3.5W
- Commercial case temperature range: 0°C to 70°C
- 3.3V power supply voltage
- ROHS 6 compliant
- Hot pluggable QSFP form factor

Product Information

PN	Data Rate	Cable Type	Fiber Diameter	Fiber Length
EQ2A10X-33CD1	100Gbps	OM3	3.0mm	1M
EQ2A10X-33CD3	100Gbps	OM3	3.0mm	3M
EQ2A10X-33CD5	100Gbps	OM3	3.0mm	5M
EQ2A10X-33CD7	100Gbps	OM3	3.0mm	7M
EQ2A10X-33CD10	100Gbps	OM3	3.0mm	10M
EQ2A10X-33CD15	100Gbps	OM3	3.0mm	15M
EQ2A10X-33CD20	100Gbps	OM3	3.0mm	20M
EQ2A10X-33CD25	100Gbps	OM3	3.0mm	25M
EQ2A10X-33CD30	100Gbps	OM3	3.0mm	30M

Note: The cable can be offered different length by customer's request, the longest cable be reached 200M.

Applications 5:

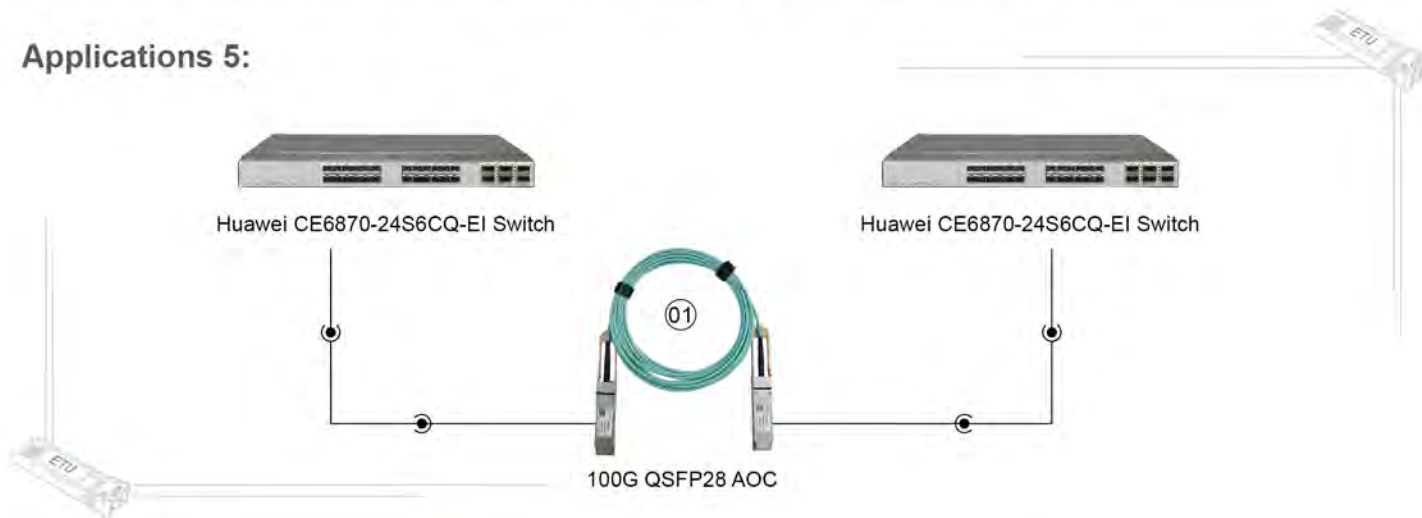

Item No	ETU PN	Description
01	EQ2A10X-33CD5	100G QSFP28 to QSFP28 AOC Cable 5M

40G QSFP+ AOC



Features

- Four-channel full-duplex active optical cable
- Transmission data rate up to 11.3Gbit/s per channel
- Reliable VCSEL array technology using multi mode fiber
- Available in standard lengths of 3, 5, 10, 15, 20, 30, 50, 100m
- Low power consumption <1.5W
- Commercial case temperature range: 0°C to 70°C
- 3.3V power supply voltage
- ROHS 6 compliant
- Hot pluggable QSFP form factor

Product information

PN	Data Rate	Cable Type	Fiber Diameter	Fiber Length
EQA4X-33CD1	40Gbps	OM3	3.0mm	1M
EQA4X-33CD3	40Gbps	OM3	3.0mm	3M
EQA4X-33CD5	40Gbps	OM3	3.0mm	5M
EQA4X-33CD7	40Gbps	OM3	3.0mm	7M
EQA4X-33CD10	40Gbps	OM3	3.0mm	10M

Note: The cable can be offered different length by customer's request, the longest cable be reached 200M.

Applications 6:

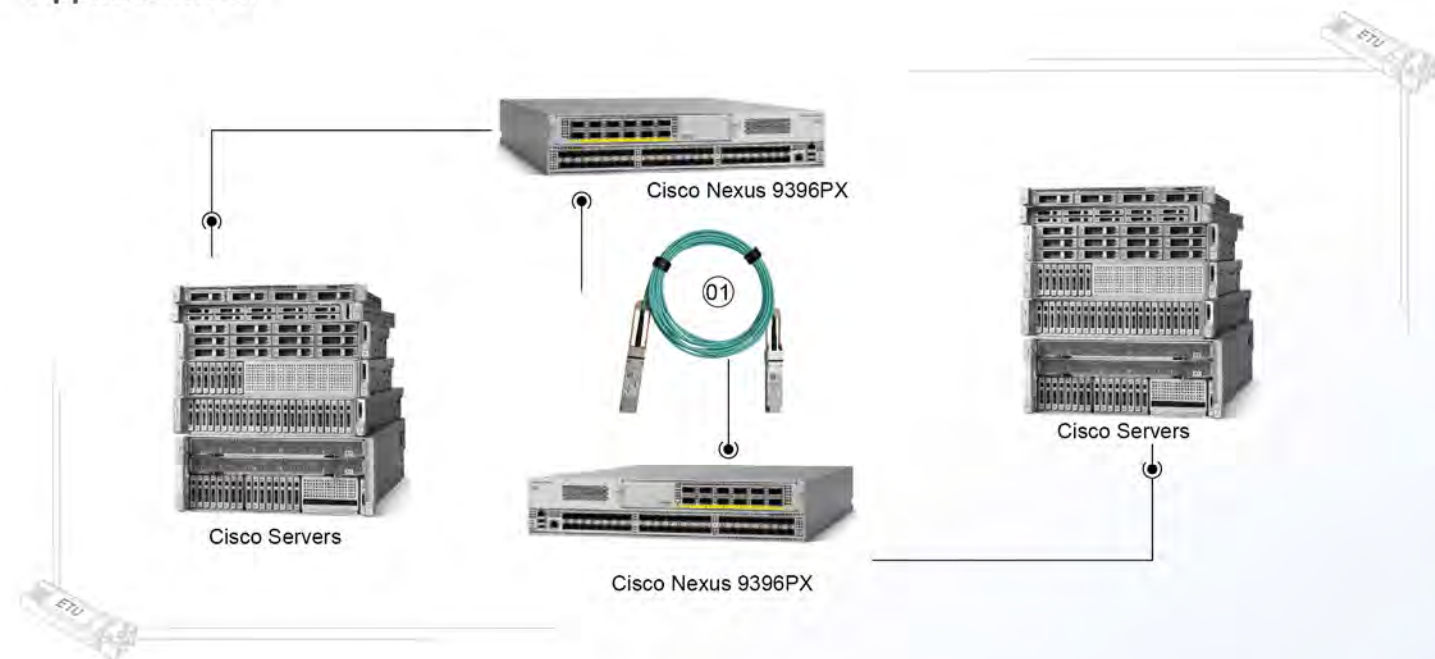

Item No	ETU PN	Description
01	EQA4X-33CD1	40G QSFP+ to QSFP+ AOC Cable 1M

40G QSFP+ to 4*10G SFP+ AOC



Features

- ❖ Electrical interface compliant to QSFP+ connector (SFF-8436) and SFP+ connectors (SFF-8431)
- ❖ Hot pluggable
- ❖ 850nm VCSEL transmitter, PIN photo-detector receiver
- ❖ Up to 30m on OM2 MMF
- ❖ Up to 100m on OM3 MMF
- ❖ Commercial case temperature range: 0°C to 70°C
- ❖ All-metal housing for superior EMI performance
- ❖ ROHS compliant (lead free)

Product Information

PN	Data Rate	Cable Type	Fiber Diameter	Fiber Length
EQA4X-34S3CD1	40Gbps	OM3	3.0mm	1M
EQA4X-34S3CD3	40Gbps	OM3	3.0mm	3M
EQA4X-34S3CD5	40Gbps	OM3	3.0mm	5M
EQA4X-34S3CD7	40Gbps	OM3	3.0mm	7M
EQA4X-34S3CD10	40Gbps	OM3	3.0mm	10M

Note: The cable can be offered different length by customer's request, the longest cable be reached 200M.

Applications 7:

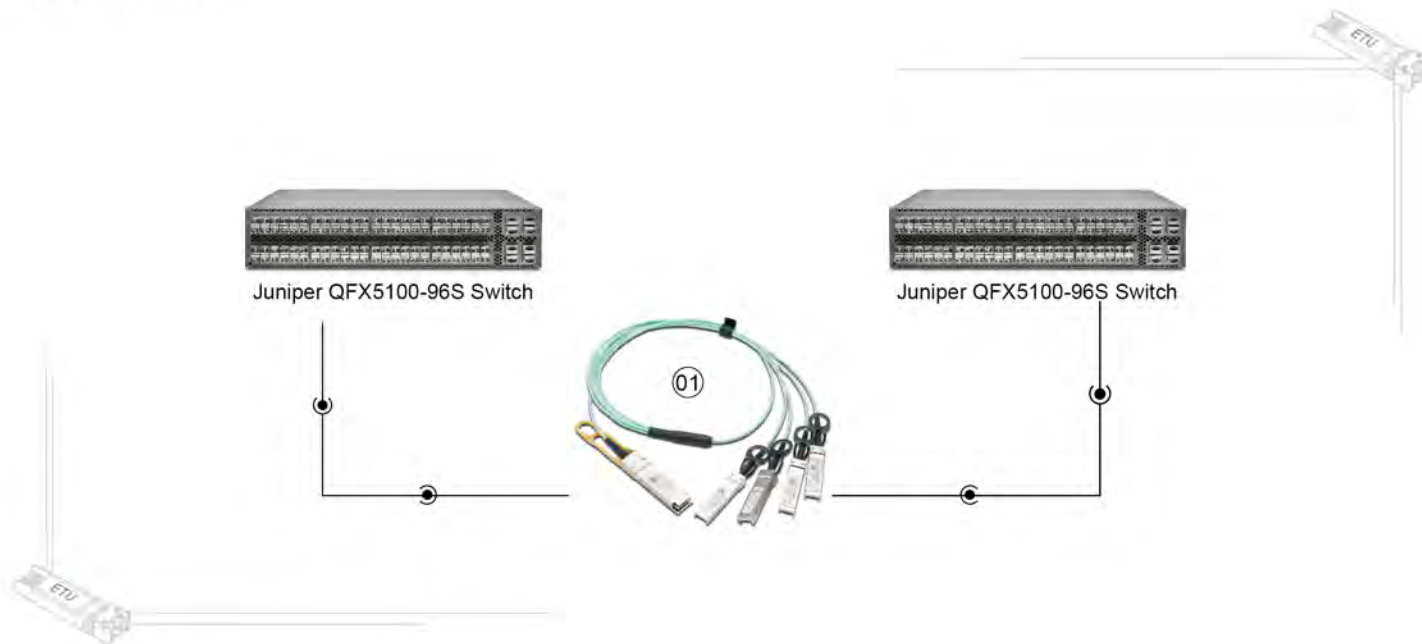

Item No	ETU PN	Description
01	EQA4X-34S3CD1	40G QSFP+ to 4X10G SFP+ AOC Cable 1M

25G SFP28 AOC



Features

- ❖ Electrical interface compliant to SFF-8431
- ❖ 850nm VCSEL laser and PIN photo-detector
- ❖ Maximum link length of 70m on OM3 MMF and 100m on OM4 MMF
- ❖ Digital diagnostics functions are available via the I2C interface
- ❖ ROHS compliant
- ❖ Hot pluggable

Product Information

PN	Data Rate	Cable Type	Fiber Diameter	Fiber Length
ES2A2X-33CD1	25Gbps	OM3	3.0mm	1M
ES2A2X-33CD3	25Gbps	OM3	3.0mm	3M
ES2A2X-33CD5	25Gbps	OM3	3.0mm	5M
ES2A2X-33CD7	25Gbps	OM3	3.0mm	7M
ES2A2X-33CD10	25Gbps	OM3	3.0mm	10M

Note: The cable can be offered different length by customer's request, the longest cable be reached 200M.

Applications 8:

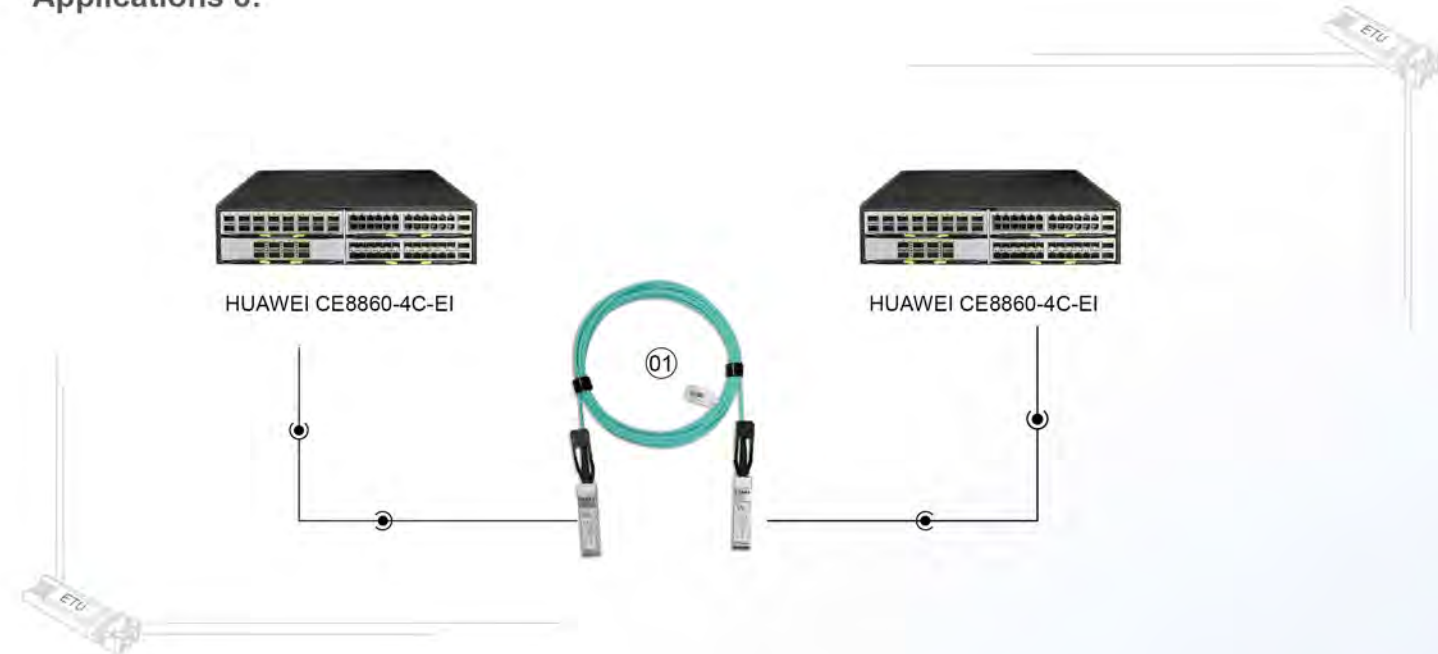

Item No	ETU PN	Description
01	ES2A2X-33CD3	25G SFP28 to SFP28 AOC Cable 3M

10G SFP+ AOC



Features

- ❖ Electrical interface compliant to SFF-8431
- ❖ Hot pluggable
- ❖ 850nm VCSEL transmitter, PIN photo-detector receiver
- ❖ Up to 300m on OM3 MMF
- ❖ Commercial case temperature range: 0°C to 70°C
- ❖ All-metal housing for superior EMI performance
- ❖ ROHS compliant (lead free)

Product Information

PN	Data Rate	Cable Type	Fiber Diameter	Fiber Length
ESAX-33CD1	10Gbps	OM3	3.0mm	1M
ESAX-33CD2	10Gbps	OM3	3.0mm	2M
ESAX-33CD3	10Gbps	OM3	3.0mm	3M
ESAX-33CD5	10Gbps	OM3	3.0mm	5M
ESAX-33CD7	10Gbps	OM3	3.0mm	7M
ESAX-33CD10	10Gbps	OM3	3.0mm	10M

Note: The cable can be offered different length by customer's request, the longest cable be reached 200M.

Applications 9:

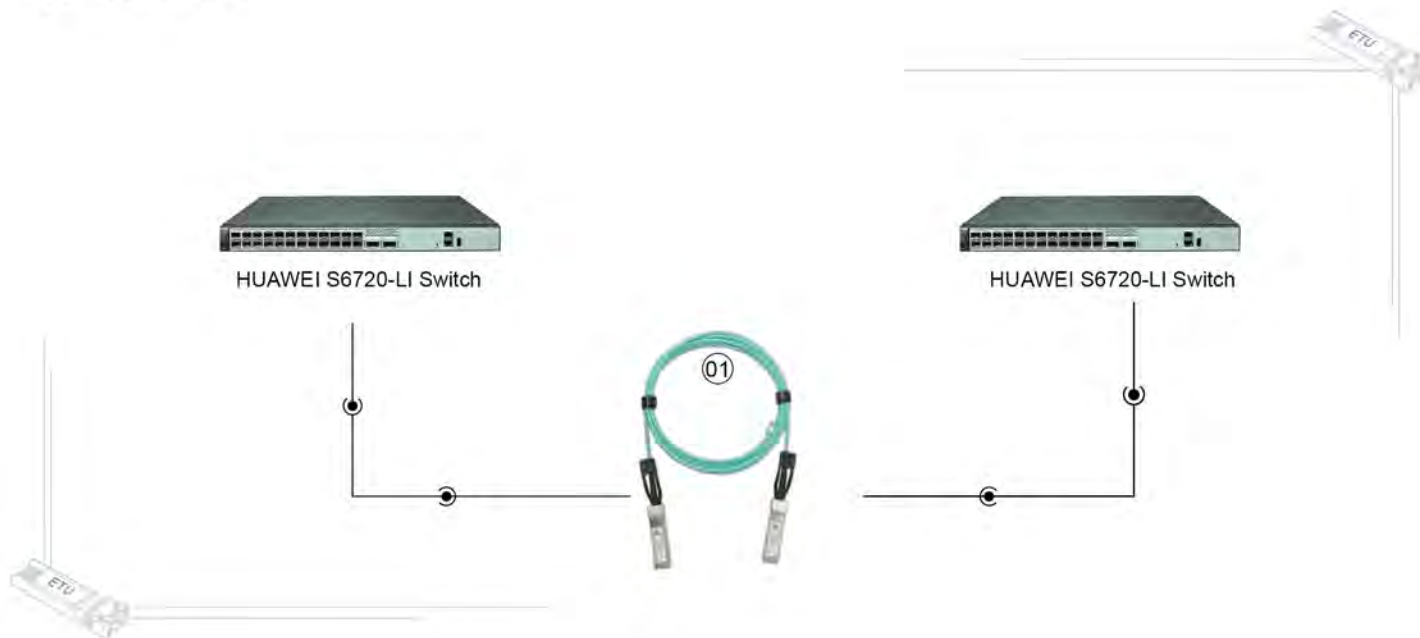

Item No	ETU PN	Description
01	ESAX-33CD1	10G SFP+ to SFP+ AOC Cable 1M

800G OSFP DAC



Features

- ❖ Compatible with IEEE 802.3ck
- ❖ Supports aggregate data rates of 800Gbps(PAM4)
- ❖ Optimized construction to minimize insertion loss and crosstalk
- ❖ Pull-to-release slide latch design
- ❖ Straight and break out assembly configurations available
- ❖ Customized cable braid termination limits EMI radiation
- ❖ Customizable EEPROM mapping for cable signature
- ❖ 26AWG and 30AWG cable
- ❖ 3.3V Power supply
- ❖ Temperature Range: 0~ 70 °C
- ❖ RoHs Compliant

Product Information

PN	Data Rate	Fiber Diameter	Fiber Length
EODP80X-34Q1CN1	800bps	30AWG	1M
EODP80X-34Q1CN2	800bps	26AWG	2M
EODP80X-34Q1CN3	800bps	26AWG	3M

400G QSFP-DD DAC



Features

- ❖ Compatible with IEEE 802.3bj and IEEE 802.3cd
- ❖ Supports aggregate data rates of 400Gbps(PAM4)
- ❖ Optimized construction to minimize insertion loss and cross talk
- ❖ Pull-to-release slide latch design
- ❖ 28AWG through 30AWG cable
- ❖ Straight and break out assembly configurations available
- ❖ Customized cable braid termination limits EMI radiation
- ❖ Customizable EEPROM mapping for cable signature
- ❖ RoHS omplia

Product Information

PN	Data Rate	Fiber Diameter	Fiber Length
EO5DP40X-330CN1	400bps	30AWG	1M
EO5DP40X-328CN2	400bps	30AWG	2M
EO5DP40X-327CN3	400bps	26AWG	3M

200G QSFP56 DAC



Features

- ❖ Compatible with IEEE 802.3bj and IEEE 802.3cd
- ❖ In accordance with the paging function in the protocol SFF-8636, paging can be selected 00H or 02H in 127 bytes
- ❖ Supports aggregate data rates of 200Gbps(PAM4)
- ❖ Optimized construction to minimize insertion loss and cross talk
- ❖ Backward compatible with existing QSFP+ connectors and cages
- ❖ Pull-to-release slide latch design
- ❖ 26AWG through 30AWG cable
- ❖ Straight and break out assembly configurations available
- ❖ Customized cable braid termination limits EMI radiation
- ❖ Customizable EEPROM mapping for cable signature
- ❖ RoHS omplia

Product Information

PN	Data Rate	Fiber Diameter	Fiber Length
EQ5DP20X-330CN1	200bps	30AWG	1M
EQ5DP20X-330CN2	200bps	26/30AWG	2M
EQ5DP20X-330CN3	200bps	26AWG	3M

Applications 10:

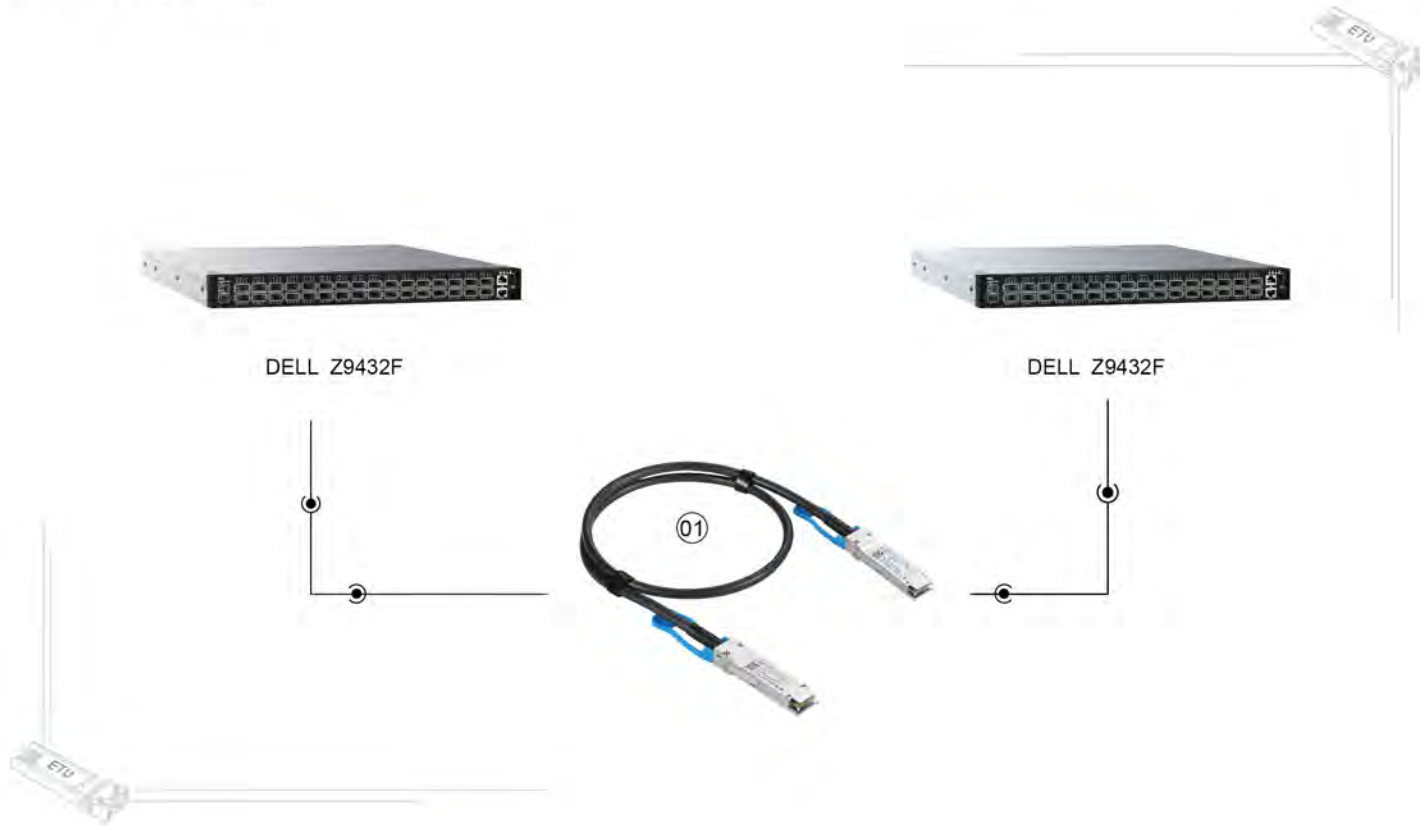

Item No	ETU PN	Description
01	EQ5DP20X-330CN1	200G QSFP56 to QSFP56 DAC 1M

100G QSFP28 DAC



Features

- ❖ Compliant with SFF-8636
- ❖ Support IEEE802.3Bj(Ethernet)
- ❖ I2C based two-wire serial interface for easy control and monitoring
- ❖ Hot pluggable
- ❖ Low crosstalk
- ❖ Low power consumption

Product Information

PN	Data Rate	Fiber Diameter	Fiber Length
EQ2DP10X-330CN1	100Gbps	30AWG	1M
EQ2DP10X-330CN2	100Gbps	30AWG	2M
EQ2DP10X-330CN3	100Gbps	30AWG	3M
EQ2DP10X-326CN5	100Gbps	26AWG	5M

Applications 11:

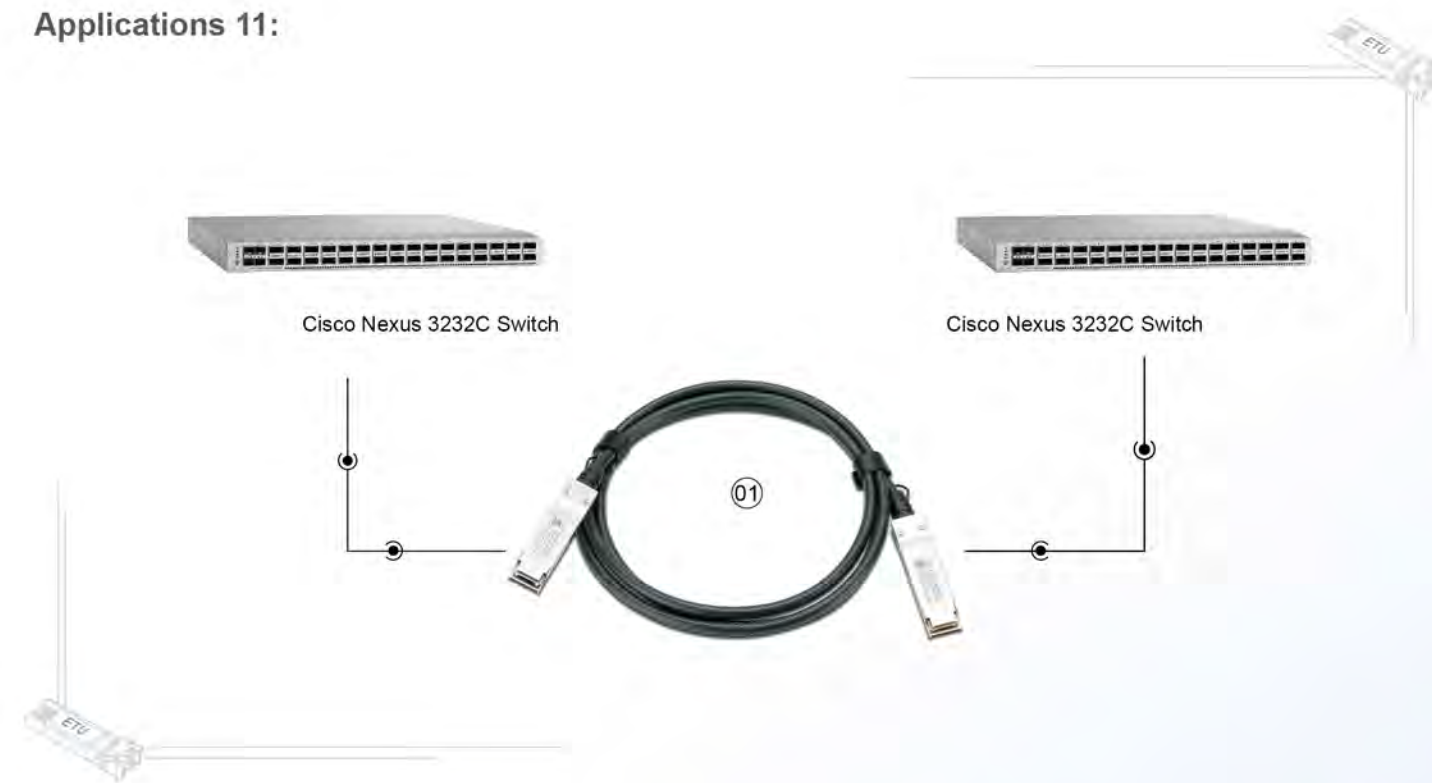

Item No	ETU PN	Description
01	ESAX-33CD1	10G SFP+ to SFP+ AOC Cable 1M

56G QSFP+ DAC



Features

- Compliant with SFF- 8436.
- Up to 14.3125Gbps data rate per channel
- Up to 7m transmission
- Operating temperature: 0~70 C
- Single 3.3V power supply
- RoHS compliant

Product Information

PN	Data Rate	Fiber Diameter	Fiber Length
EQDP5X-33CN1	56Gbps	30AWG	1M
EQDP5X-33CN2	56Gbps	30AWG	2M
EQDP5X-33CN3	56Gbps	30AWG	3M
EQ2DP10X-326CN4	56Gbps	26AWG	5M

Applications 12:

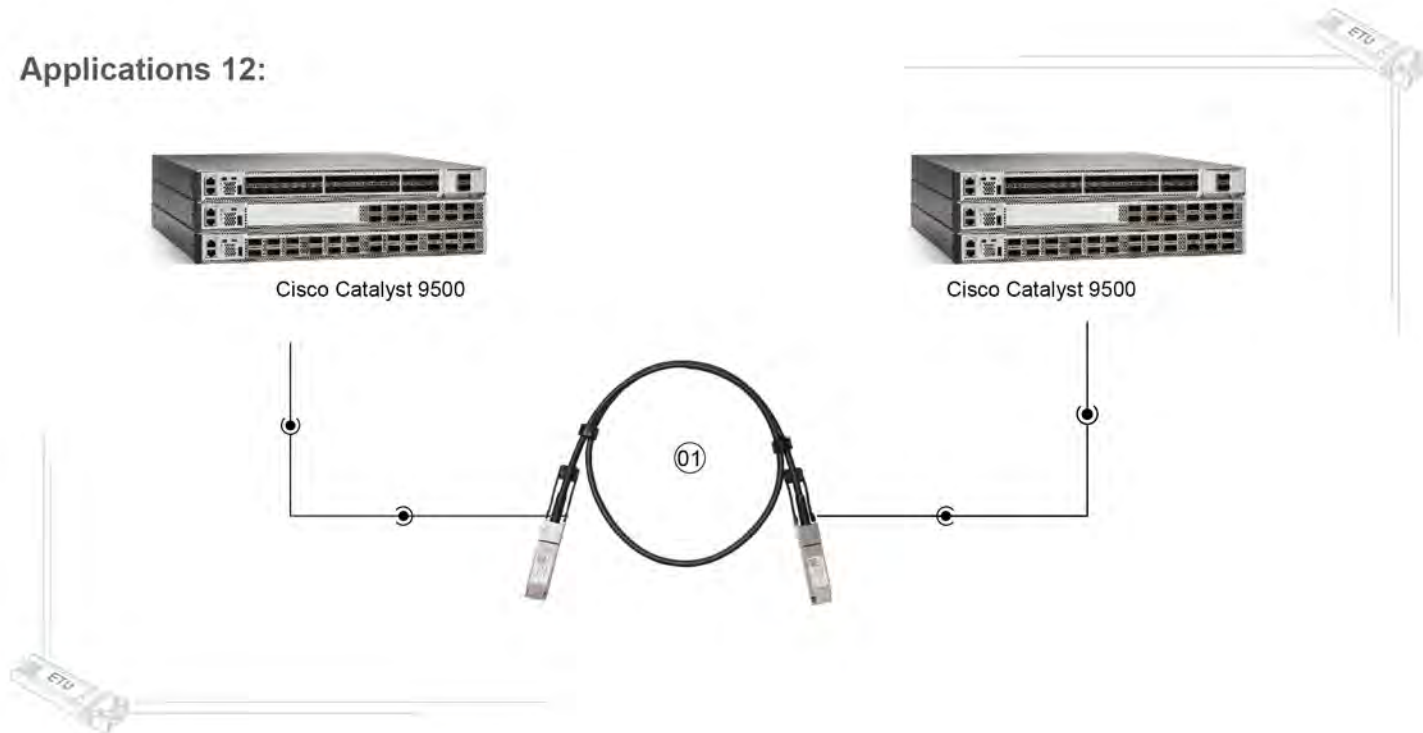

Item No	ETU PN	Description
01	EQDP5X-330CN1	56G QSFP+ TO QSFP+ DAC Passive Cable 1M

40G QSFP+ DAC



Features

- Compliant QSFP MSA specifications
- Fully compatible with IEEE802.3ba and infiniband QDR specifications
- 40Gb/s total bandwidth
- Single 3.3V power supply, low power consumption <1.5W
- All-metal housing for superior EMI performance
- 30 AWG to 24 AWG cable sizes available
- ROHS compliant

Product Information

PN	Data Rate	Fiber Diameter	Fiber Length
EQDP4X-330CN1	40Gbps	30AWG	1M
EQDP4X-330CN2	40Gbps	30AWG	2M
EQDP4X-330CN3	40Gbps	30AWG	3M
EQDP4X-326CN5	40Gbps	26AWG	5M
EQDP4X-324CN7	40Gbps	24AWG	7M

Applications 13:

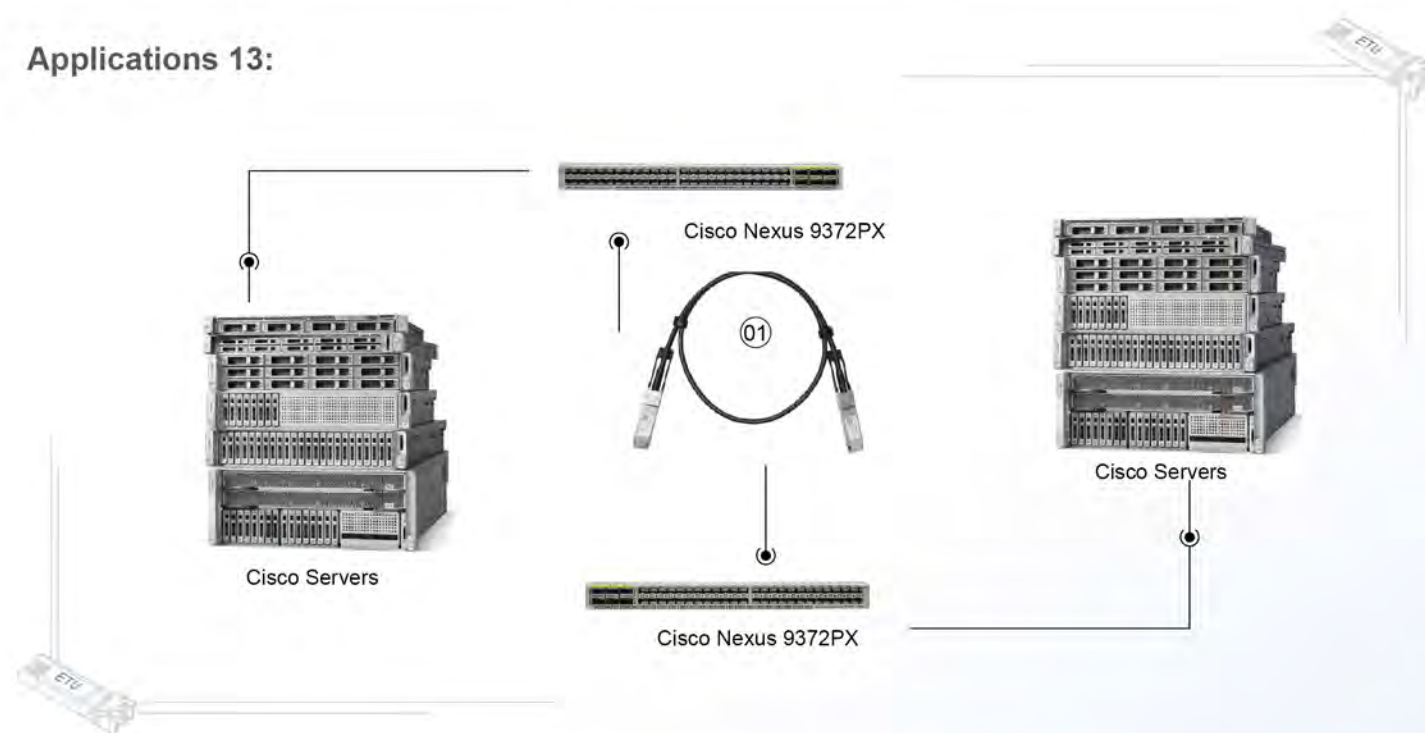

Item No	ETU PN	Description
01	EQDP4X-330CN1	40G QSFP+ to QSFP+ DAC Passive Cable 1M

40G QSFP+ to 4*10G SFP+ DAC



Features

- ❖ Connector A: (1) QSFP 40Gbps rated connector (SFF-8436 compliant)
- ❖ Connector B: (4) SFP+ 10Gbps rated connectors (SFF-8431 compliant)
- ❖ Economically links up a QSFP port with an upstream 10GbE-SFP+ switch
- ❖ Fully compliant to the latest SFP+ & QSFP MSA (Multi-source-agreement)
- ❖ Supports all current 10-Gigabit Ethernet and 40-Gigabit Ethernet standards
- ❖ Fully ROHS compliant for environmental protection

Product Information

PN	Data Rate	Fiber Diameter	Fiber Length
EQDP4X-34SCN1	40Gbps	30AWG	1M
EQDP4X-34SCN2	40Gbps	30AWG	2M
EQDP4X-34SCN3	40Gbps	30AWG	3M
EQDP4X-34SCN5	40Gbps	26AWG	5M
EQDP4X-34SCN7	40Gbps	24AWG	7M

Applications 14:

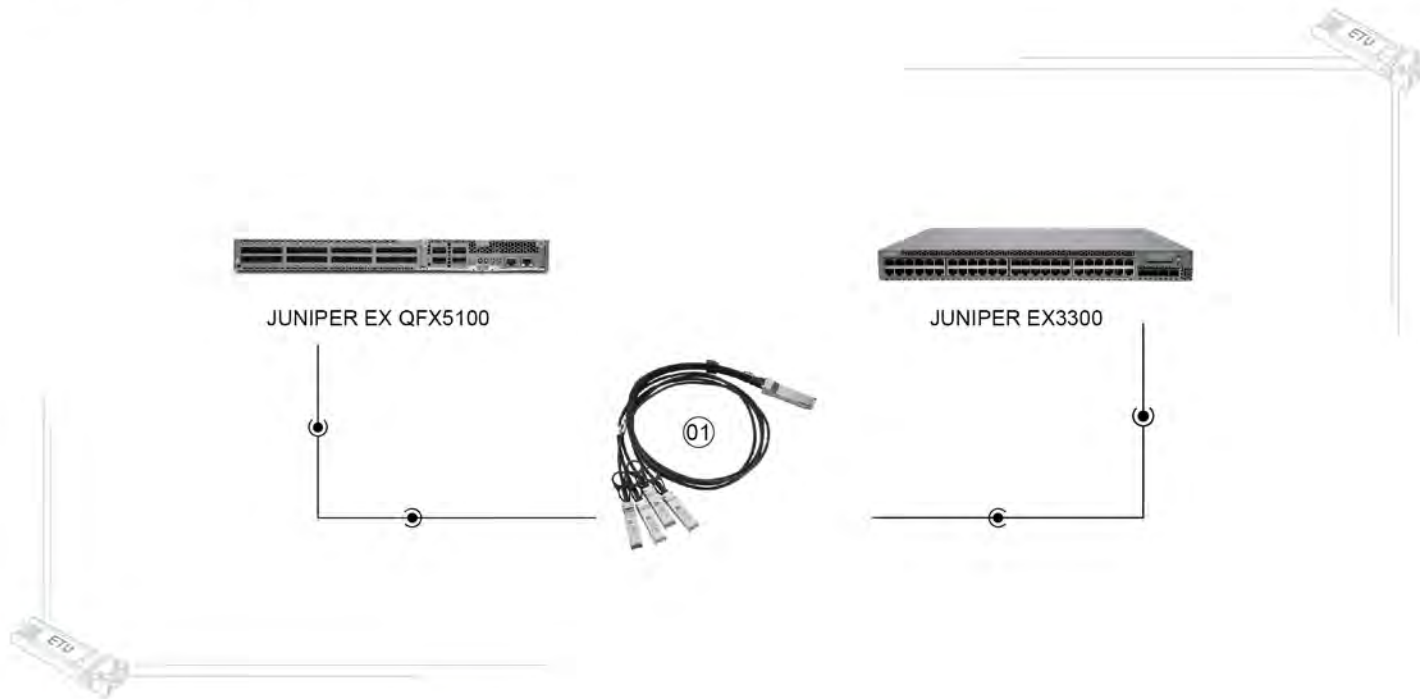

Item No	ETU PN	Description
01	EQDP4X-34SCN1	40G QSFP+ to 4*SFP+ DAC Passive Cable 1M

25G SFP28 DAC



Features

- ❖ Up to 25Gb/s data rate SFF-8402 compliant
- ❖ Single 3.3V supply voltage
- ❖ BER better than 10⁻¹⁵
- ❖ Hot pluggable
- ❖ Compliant with SFF-8432
- ❖ Compliant with IEEE 802.3by
- ❖ Compliant with ROHS
- ❖ Commercial case temperature range: 0°C to 70°C

Product Information

PN	Data Rate	Fiber Diameter	Fiber Length
ES2DP2X-330CN1	25Gbps	30AWG	1M
ES2DP2X-330CN2	25Gbps	30AWG	2M
ES2DP2X-330CN3	25Gbps	30AWG	3M
ES2DP2X-326CN5	25Gbps	26AWG	5M

Applications 15:

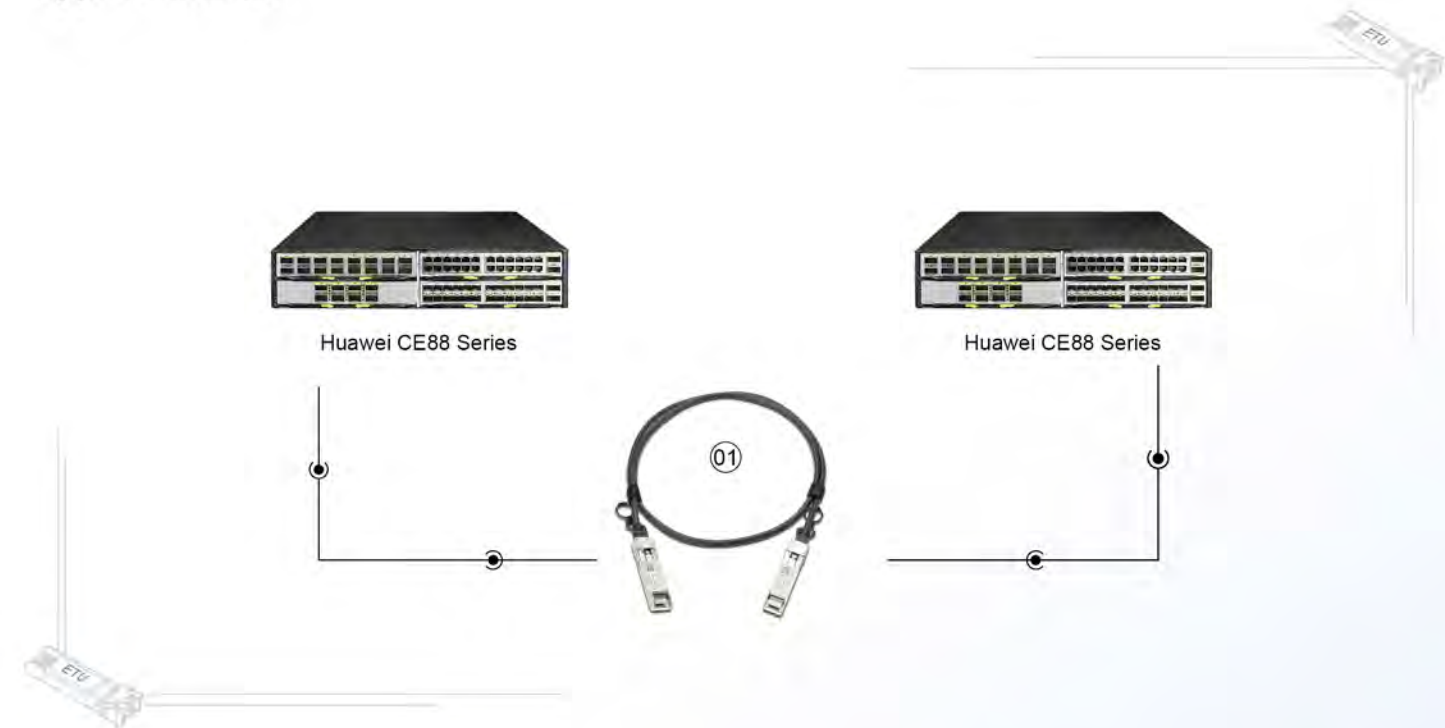

Item No	ETU PN	Description
01	ES2DP2X- 330CN1	25G SFP28 to SFP28 DAC Cable 1M

10G SFP+ DAC



Features

- ❖ Supports multi-gigabit data rates up to 10.5Gbps
- ❖ Supports 1x, 2x, 4x and 8x fiber channel data rates
- ❖ Hot-pluggable SFP 20PIN footprint
- ❖ Serial ID module on MOD(0-2)
- ❖ AC coupling of PECL signals
- ❖ EMI/EMC performance
- ❖ Low power consumption < 0.5W
- ❖ Power supply :+3.3V
- ❖ Compliant to SFP+ MSA
- ❖ Commercial case temperature range: 0°C to 70°C
- ❖ ROHS compliance

Product Information

PN	Data Rate	Fiber Diameter	Fiber Length
ESDPX-330CN0	10Gbps	30AWG	0.5M
ESDPX-330CN1	10Gbps	30AWG	1M
ESDPX-330CN2	10Gbps	30AWG	2M
ESDPX-330CN3	10Gbps	30AWG	3M
ESDPX-324CN5	10Gbps	24AWG	5M
ESDPX-324CN7	10Gbps	24AWG	7M
ESDPX-324CN10	10Gbps	24AWG	10M
ESDPX-324CN15	10Gbps	24AWG	15M

Note: The cables are divided into active and passive. It is suggested that choose active cable if 7M or more.

Applications 16:



Item No	ETU PN	Description
01	ESDPX-330CN1	10G SFP+ to SFP+ DAC Passive Cable 1M

10G XFP Transceiver



Features

- ❖ Supports 9.95Gb/s to 11.1Gb/s bit rates
- ❖ 3.3V power supply and TTL logic interface
- ❖ LC connector
- ❖ Hot pluggable
- ❖ XFP MSA rev 4.5 compliant
- ❖ DDM function

Product Information

Model No.	Data Rate	Package	Wavelength(nm)	Distance	Output Power	Temp.(°C)	Sensitivity	Interface	Source
EXB23X-3LCD10	10G	XFP	1270/1330	10KM	-6~-0.5	0~70	<-14.4	LC	DFB+PIN
EXB32X-3LCD10	10G	XFP	1330/1270	10KM	-6~-0.5	0~70	<-14.4	LC	DFB+PIN
EXB23X-3LCD20	10G	XFP	1270/1330	20KM	-6~-0.5	0~70	<-14.4	LC	DFB+PIN
EXB32X-3LCD20	10G	XFP	1330/1270	20KM	-6~-0.5	0~70	<-14.4	LC	DFB+PIN
EXB23X-3LCD40	10G	XFP	1270/1330	40KM	-1~3	0~70	<-15.8	LC	DFB+PIN
EXB32X-3LCD40	10G	XFP	1330/1270	40KM	-1~3	0~70	<-15.8	LC	DFB+PIN
EXB23X-3LCD60	10G	XFP	1270/1330	60KM	2~6	0~70	<-20	LC	DFB+PIN
EXB32X-3LCD60	10G	XFP	1330/1270	60KM	2~6	0~70	<-20	LC	DFB+PIN
EXB45X-3LCD80	10G	XFP	1490/1550	80KM	0~4	0~70	<-30	LC	DFB+PIN
EXB54X-3LCD80	10G	XFP	1550/1490	80KM	-1~3	0~70	<-30	LC	DFB+PIN
EX85X-3LCD03	10G	XFP	850	300M	-6~-1	0~70	<-10	LC	VSCSEL+PIN
EX31X-3LCD10	10G	XFP	1310	10KM	-6~-0.5	0~70	<-14.4	LC	DFB+PIN
EX31X-3LCD20	10G	XFP	1310	20KM	-6~-0.5	0~70	<-14.4	LC	DFB+PIN
EX31X-3LCD40	10G	XFP	1310	40KM	-1~4	0~70	<-16.4	LC	DFB+PIN
EX55X-3LCD40	10G	XFP	1550	40KM	-1~4	0~70	<-16.4	LC	EML+PIN
EX55X-3LCD80	10G	XFP	1550	80KM	0~5	0~70	<-24	LC	EML+APD
EXCxxX-3LCD10	10G	XFP	1270~1450	10KM	-1~3	0~70	<-15	LC	CWDM+PIN
EXCxxX-3LCD40	10G	XFP	1470~1610	40KM	-1~3	0~70	<-15	LC	CWDM+PIN
EXCxxX-3LCD80	10G	XFP	1470~1610	80KM	0~5	0~70	<-24	LC	CWDM+APD
EXDxxX-3LCD40	10G	XFP	1528.77~1563.86	40KM	-1~4	0~70	<-15.8	LC	DWDM+PIN
EXDxxX-3LCD80	10G	XFP	1528.77~1563.86	80KM	0~5	0~70	<-24	LC	DWDM+APD

10G SFP+ Single Fiber Transceiver



Features

- Single LC connector
- Supports hot-pluggable
- Excellent ESPD protection
- 1270nm transmitter and 1330nm receiver
- Distance up to 20Km on 9/125um SMF
- ROHS compliant and lead-free
- Commercial case temperature range: 0°C to 70°C
- Single 3.3V power supply and low power dissipation <1.0W
- Support 9.95328Gbps and 10.3125Gbps data rate
- Compliant with IEEE 802.3ae 10GBASE-LR and 10GBASE-LW
- Compliant with SFF-8431 SFP+ MSA and SFF-8472
- Digital diagnostic monitor function

Product Information

Model No.	Data Rate	Package	Wavelength(nm)	Distance	Output Power	Temp.(°C)	Sensitivity	Interface	Source
ESB23X-3LCD10	10G	SFP+	1270/1330	10KM	-6~-0.5	0~70	<-14.4	LC	DFB+PIN
ESB32X-3LCD10	10G	SFP+	1330/1270	10KM	-6~-0.5	0~70	<-14.4	LC	DFB+PIN
ESB23X-3LCD20	10G	SFP+	1270/1330	20KM	-6~-0.5	0~70	<-14.4	LC	DFB+PIN
ESB32X-3LCD20	10G	SFP+	1330/1270	20KM	-6~-0.5	0~70	<-14.4	LC	DFB+PIN
ESB23X-3LCD40	10G	SFP+	1270/1330	40KM	-1~3	0~70	<-15.8	LC	DFB+PIN
ESB32X-3LCD40	10G	SFP+	1330/1270	40KM	-1~3	0~70	<-15.8	LC	DFB+PIN
ESB23X-3LCD60	10G	SFP+	1270/1330	60KM	0~5	0~70	<-20	LC	DFB+PIN
ESB32X-3LCD60	10G	SFP+	1330/1270	60KM	0~5	0~70	<-20	LC	DFB+PIN
ESB45X-3LCD80	10G	SFP+	1490/1550	80KM	0~4	0~70	<-23	LC	DFB+PIN
ESB54X-3LCD80	10G	SFP+	1550/1490	80KM	0~4	0~70	<-23	LC	DFB+PIN
ESB45X-3LCD100	10G	SFP+	1490/1550	100KM	1~6	0~70	<-25	LC	EML+APD
ESB54X-3LCD100	10G	SFP+	1550/1490	100KM	1~6	0~70	<-25	LC	EML+APD

10G SFP+ Dual Fiber Transceiver



Features

- Hot pluggable
- 10Gb/s serial optical interface
- Compliant with SFP+ MSA
- SFP MSA package with duplex LC connector
- Digital diagnostic monitor interface
- Very low EMI and excellent ESPD protection
- High transmission margin
- +3.3V single power supply
- Below 1.5W power consumption
- SFP mechanical interface
- Wide data-rate range

Product Information

Model No.	Data Rate	Package	Wavelength(nm)	Distance	Output Power	Temp.(°C)	Sensitivity	Interface	Source
ES85X-3LCD03	10G	SFP+	850	300M	-6~-1	0~70	<-10	LC	VCSEL+PIN
ES31X-3LCD10	10G	SFP+	1310	10KM	-6~-0.5	0~70	<-14.4	LC	DFB+PIN
ES31X-3LCD20	10G	SFP+	1310	20KM	-6~-0.5	0~70	<-14.4	LC	DFB+PIN
ES31X-3LCD40	10G	SFP+	1310	40KM	-1~4	0~70	<-16.4	LC	DFB+PIN
ES55X-3LCD40	10G	SFP+	1550	40KM	-1~4	0~70	<-16.4	LC	EML+PIN
ES55X-3LCD80	10G	SFP+	1550	80KM	0~5	0~70	<-24	LC	EML+APD

Applications 17:

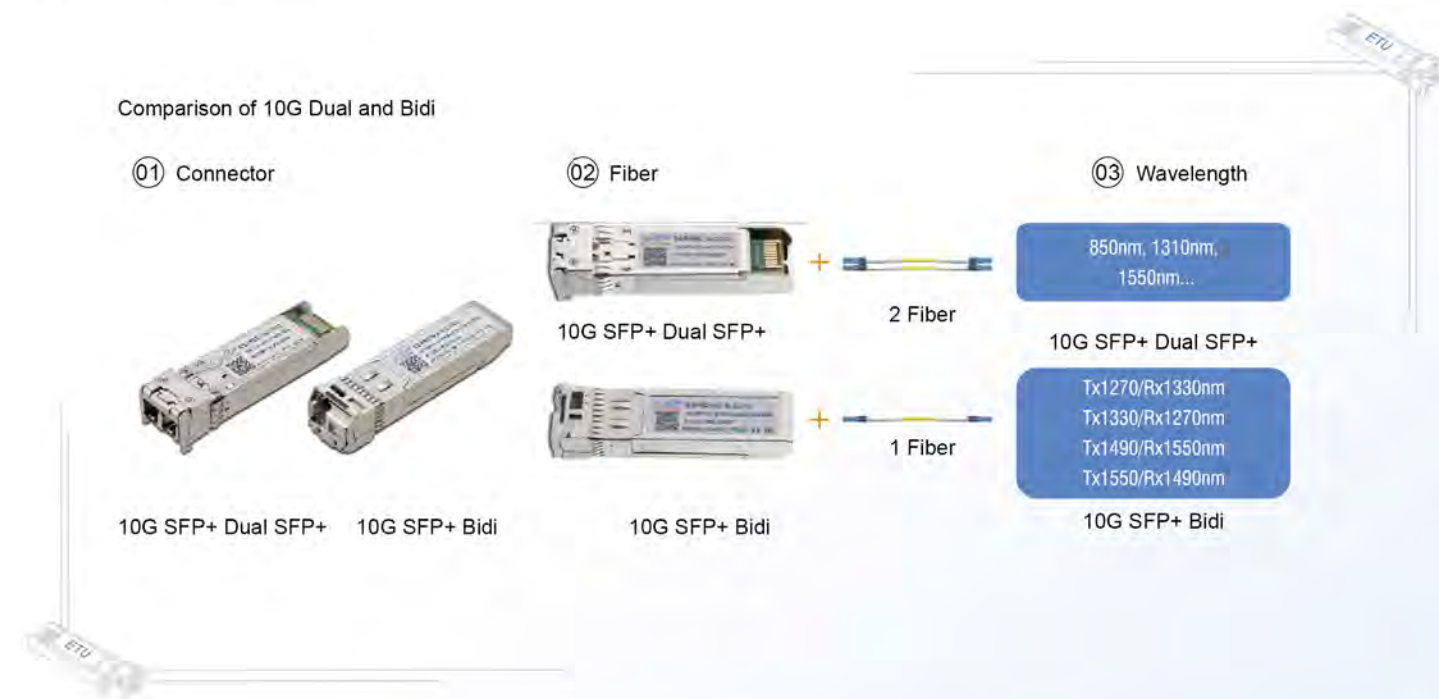

10G SFP+ CWDM/DWDM Transceiver



Features

- 10Gb/s serial optical interface compliant to 802.3ae 10GBASE-ER/EW
- Electrical interface compliant to SFF-8431 specifications for enhanced 8.5 and 10 Gigabit small form factor pluggable module "SFP+"
- 2-wire interface for management specification compliant with SFF 8472
- Digital diagnostic monitoring interface for optical transceivers eye safety designed to meet laser class1 compliant with IEC60825-1
- Commercial case temperature range: 0°C to 70°C
- Metal enclosure for low EMI
- Low power consumption advanced firmware allow customer-system encryption information to be stored in transceiver
- Single +3.3V power supply

Product Information

Model No.	Data Rate	Package	Wavelength(nm)	Distance	Output Power	Temp.(°C)	Sensitivity	Interface	Source
ESCxxX-3LCD10	10G	SFP+	1270~1610	10KM	-6~-0.5	0~70	<-14.4	LC	CWDM+PIN
ESCxxX-3LCD20	10G	SFP+	1270~1610	20KM	-6~-0.5	0~70	<-14.4	LC	CWDM+PIN
ESCxxX-3LCD40	10G	SFP+	1470~1610	40KM	-1~3	0~70	<-15.8	LC	EML+PIN
ESCxxX-3LCD80	10G	SFP+	1470~1610	80KM	0~5	0~70	<-24	LC	EML+APD
ESDxxX-3LCD40	10G	SFP+	1528.77~1563.86	40KM	-1~4	0~70	<-15.8	LC	EML+PIN
ESDxxX-3LCD80	10G	SFP+	1528.77~1563.86	80KM	0~5	0~70	<-24	LC	EML+APD

Applications 18:

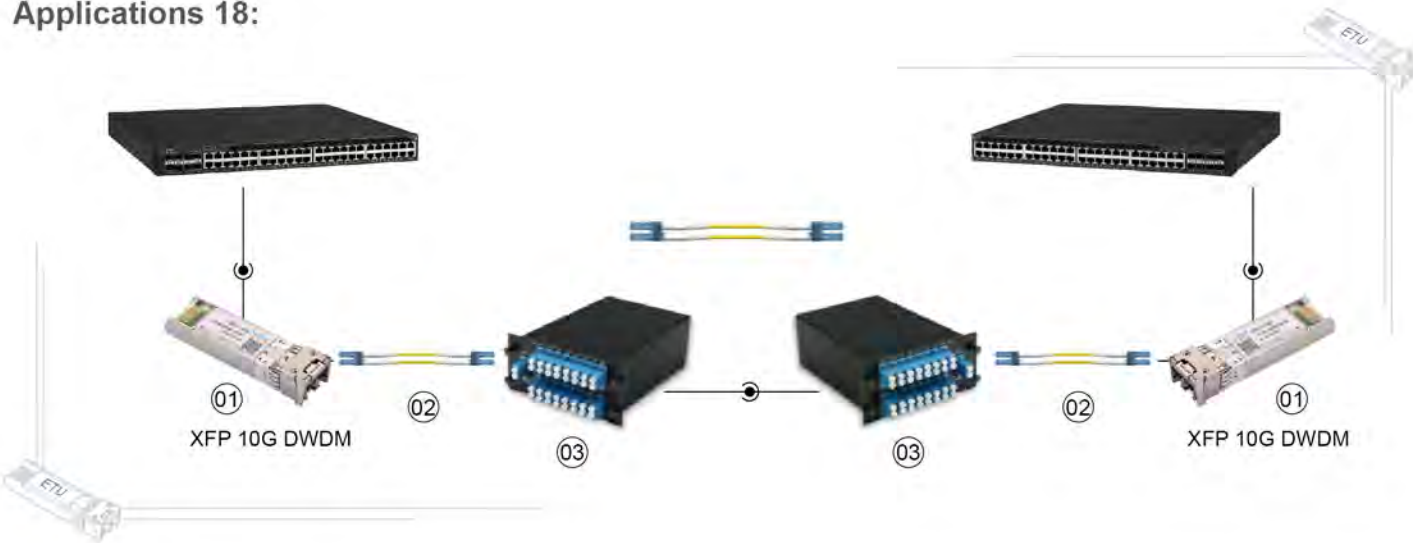

Item No	ETU PN	Description
01	ESCxxX-3LCD20	10G SP+ CWDM 20KM DDM
02	Patch Cord	LC/UPC-LC/UPC SM DX OS2
03	Mux/Demux	16 Channels 1470-1610nm Dual Fiber CWDM Mux/Demux

8G SFP+ Dual Fiber Transceiver



Features

- Up to 8.5Gb/s Bi-directional data links
- Hot pluggable SFP+ footprint
- Built-in digital diagnostic in functions
- Duplex LC connector
- Single 3.3V power supply
- Commercial case temperature range: 0°C to 70°C
- ROHS6 compliant (lead free)

Product Information

Model No.	Data Rate	Package	Wavelength(nm)	Distance	Output Power	Temp.(°C)	Sensitivity	Interface	Source
ES8585-3LCD03	8G	SFP+	850	300M	-6~-1	0~70	<-10	LC	VCSEL+PIN
ES3185-3LCD2	8G	SFP+	1310	2KM	-9~3	0~70	<-18	LC	FP+PIN
ES3185-3LCD10	8G	SFP+	1310	10KM	-6~-0.5	0~70	<-14.4	LC	DFB+PIN

Applications 19:

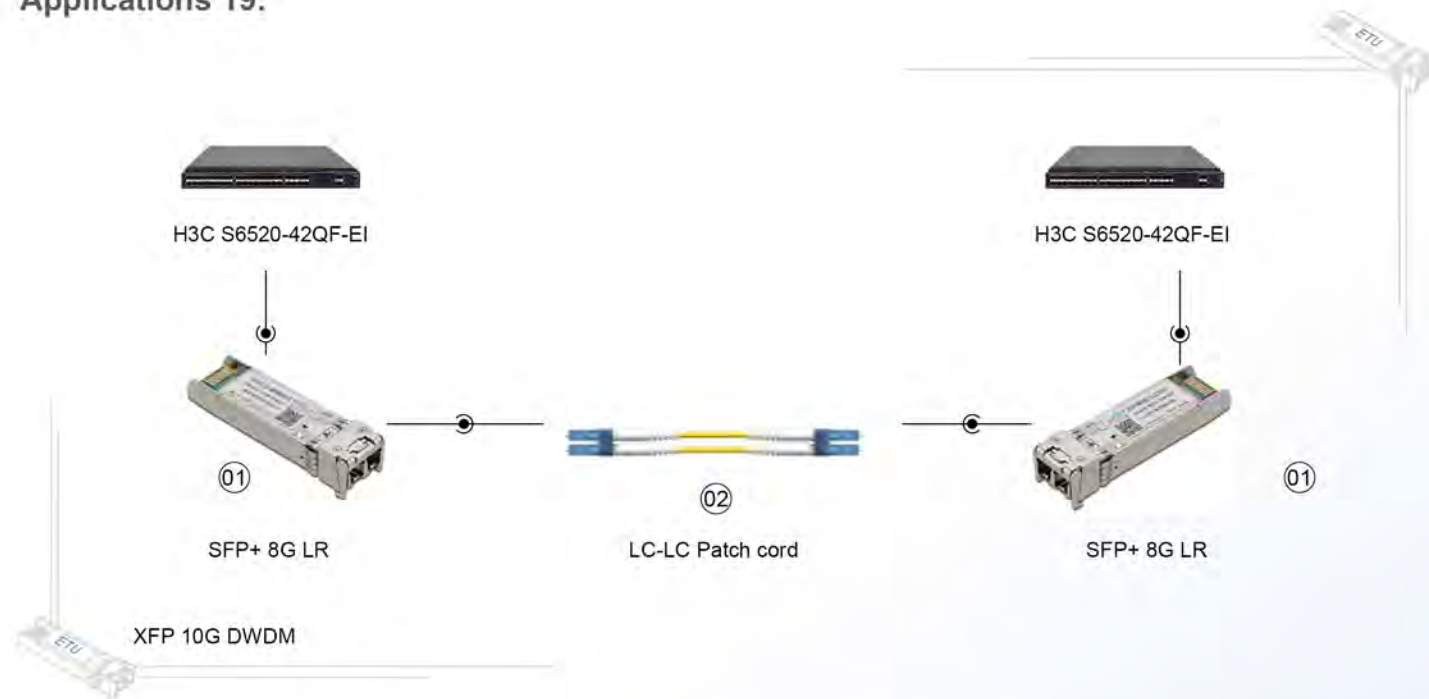

Item No	ETU PN	Description
01	ES3185-3LCD10	8G SFP+ 1310nm 10KM DDM
02	Patch Cord	LC/UPC-LC/UPC SM DX OS2

Copper Transceiver



Features

- Supports 10Gbase-T / 5Gbase-T / 2.5Gbase-T / 1000base-T
- Hot-pluggable SFP footprint
- Compact RJ-45 connector assembly
- ROHS compliant and lead free
- Single +3.3V power supply
- 10 Gigabit Ethernet over Cat 6a cable
- Ambient operating temperature: 0°C to +65°C

Product Information

Model No.	Data Rate	Distance	Temp.(C)	Interface
ES-T1-R	1000M only	100M	0~70	RJ45
ES-T2-R	10/100/1000M	100M	0~70	RJ45
ES-T3-R	10/100M	100M	0~70	RJ45
ES-T4-R	1000M	100M	-40~+85	RJ45
ES-T5-R	10G	30M	0~+65	RJ45
ES-T5-R-1	10G	30M	0~+65	RJ45
ES-T6-R	10G	80M	0~+65	RJ45

Applications 20:

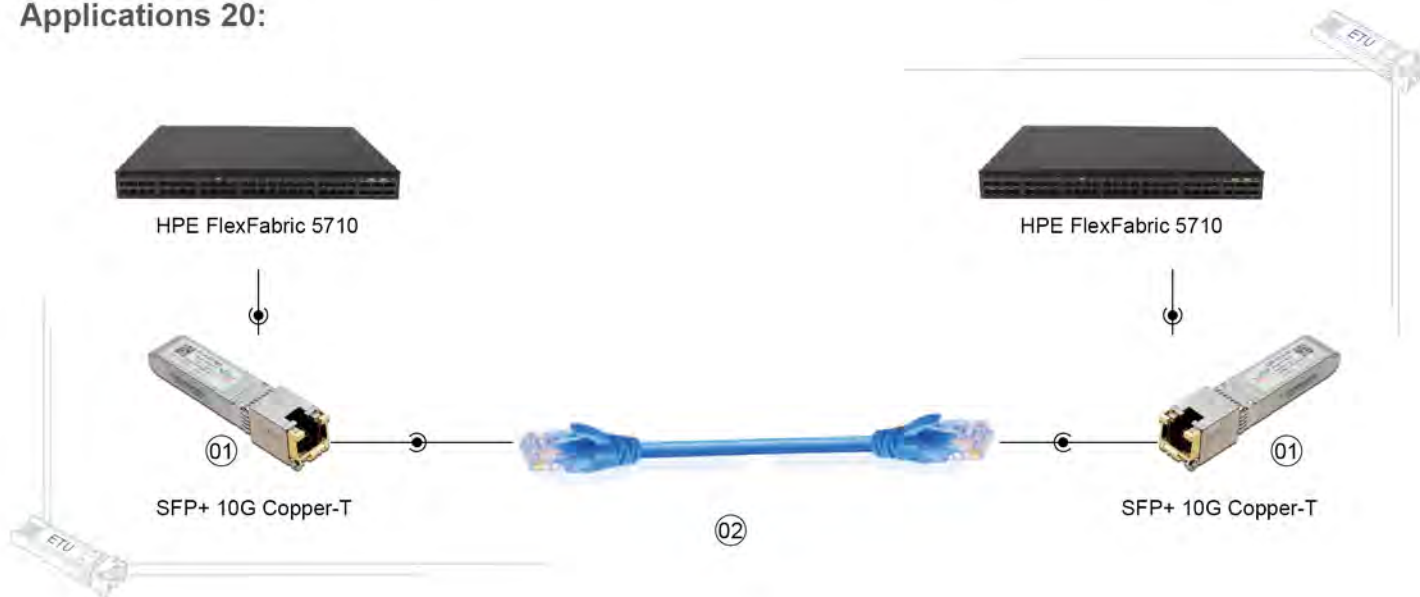

Item No	ETU PN	Description
01	ES-T5-R	10G SFP+ Copper-T RJ45 30m
02	Cat6 Cable	Cat6 UTP Cable

40Gbps QSFP to 10G SFP+ Converter



Features

- Trouble-free installation and network bring-up
- Compliant to industry standards :QSFP+ MSA SFF-8436 / SFP+ MSA SFF-8431
- Precision process control for minimization of pair-to-pair skew
- 1 independent duplex channels operating at 10Gbps/2.5Gbps/5Gbps
- All-metal housing for superior EMI performance
- 100 ohm differential impedance system
- Operating case temperature: -20 to 85 C
- Built-in digital diagnostic functions
- Low insertion loss
- Low crosstalk
- Secure latching mechanism
- RoHS compliant

Applications 21:

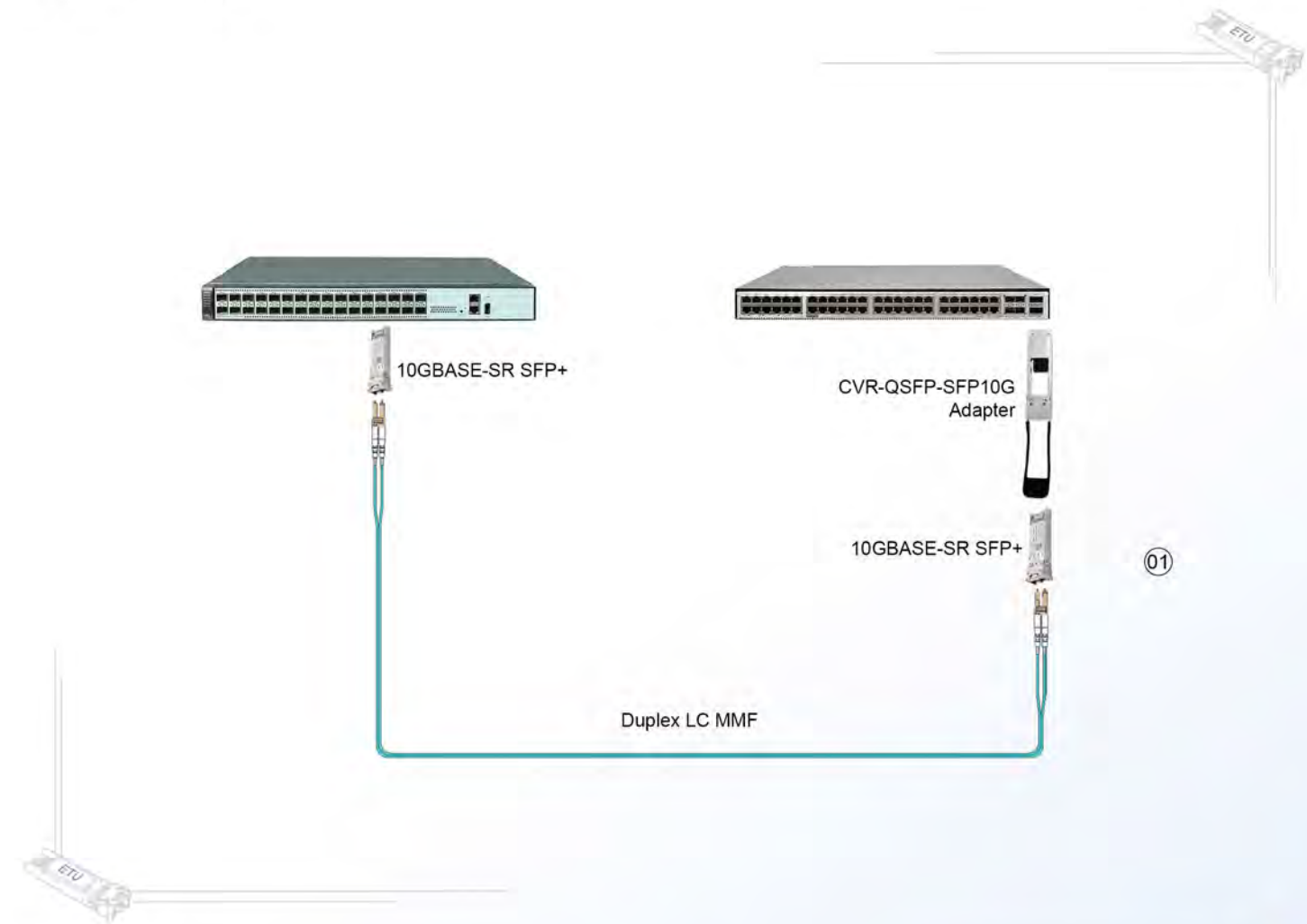

2.5G SFP Single Fiber Transceiver



Features

- ◆ Dual data-rate of 2.488Gbps/2.125Gbps operation
- ◆ Compliant with SFP MSA and SFF-8472 with simplex LC receptacle
- ◆ Digital diagnostic monitoring: internal calibration or external calibration
- ◆ Compatible with SONET OC-48 system
- ◆ Compatible with ROHS
- ◆ +3.3V single power supply
- ◆ Commercial case temperature range: 0°C to 70°C



Product Information

Model No.	Data Rate	Package	Wavelength(nm)	Distance	Output Power	Temp.(°C)	Sensitivity	Interface	Source
ESB3524-3LCD20	2.5G	SFP	1310/1550	20KM	-5~0	0~70	<-18	LC	DFB+PIN
ESB5324-3LCD20	2.5G	SFP	1550/1310	20KM	-5~0	0~70	<-18	LC	DFB+PIN
ESB3524-3LCD40	2.5G	SFP	1310/1550	40KM	-5~0	0~70	<-19	LC	DFB+PIN
ESB5324-3LCD40	2.5G	SFP	1550/1310	40KM	-5~0	0~70	<-19	LC	DFB+PIN
ESB4524-3LCD80	2.5G	SFP	1490/1550	80KM	0~5	0~70	<-24	LC	DFB+APD
ESB5424-3LCD80	2.5G	SFP	1550/1490	80KM	0~5	0~70	<-24	LC	DFB+APD

2.5G SFP Dual Fiber Transceiver



Features

- ◆ Data-rate of 2.67Gbps operation
- ◆ Compliant with SFP MSA and SFF-8472 with duplex LC receptacle
- ◆ Digital diagnostic monitoring: internal calibration or external calibration
- ◆ Compatible with SONET OC-24-LR-1
- ◆ Compatible with ROHS
- ◆ +3.3V single power supply
- ◆ Commercial case temperature range: 0°C to 70°C



Product Information

Model No.	Data Rate	Package	Wavelength(nm)	Distance	Output Power	Temp.(°C)	Sensitivity	Interface	Source
ES8524-3LCD03	2.5G	SFP	850	300M	-10~-4	0~70	<-18	LC	VCSEL+PIN
ES3124-3LCD2	2.5G	SFP	1310	2KM	-9~-3	0~70	<-18	LC	FP+PIN
ES3124-3LC20	2.5G	SFP	1310	20KM	-5~0	0~70	<-18	LC	DFB+PIN
ES3124-3LC40	2.5G	SFP	1310	40KM	-5~0	0~70	<-19	LC	DFB+PIN
ES5524-3LC80	2.5G	SFP	1550	80KM	0~5	0~70	<-26	LC	DFB+APD
ES5524-3LC120	2.5G	SFP	1550	120KM	1~6	0~70	<-30	LC	DFB+APD

Applications 22:

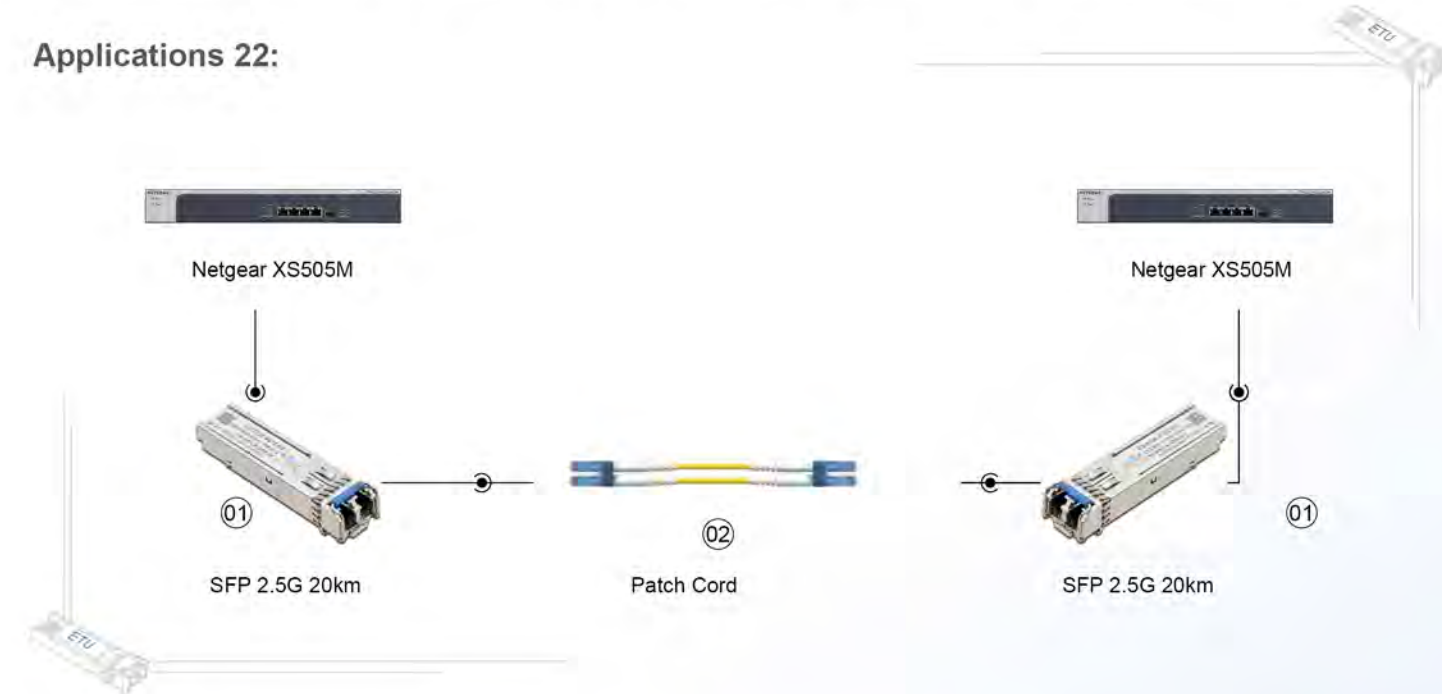

Item No	ETU PN	Description
01	ES3124-3LCD20	2.5G SFP 1310nm 20KM
02	Patch Cord	LC/UPC-LC/UPC SM DX OS2

1.25G SFP Single Fiber Transceiver



Features

- ◆ Dual data-rate of 1.25Gbps/1.063Gbps operation
- ◆ Compliant with SFP MSA and SFF-8472 with simplex LC receptacle
- ◆ Digital diagnostic monitoring: internal calibration or external calibration
- ◆ Compatible with SONET OC-24-LR-1
- ◆ Compatible with ROHS
- ◆ +3.3V single power supply
- ◆ Commercial case temperature range: 0°C to 70°C

Product Information

Model No.	Data Rate	Package	Wavelength(nm)	Distance	Output Power	Temp.(°C)	Sensitivity	Interface	Source
ESB3512-3LCD3	1.25G	SFP	1310/1550	3KM	-10~-4	0~70	<-20	LC	FP+PIN
ESB5312-3LCD3	1.25G	SFP	1550/1310	3KM	-10~-4	0~70	<-20	LC	FP+PIN
ESB3512-3LCD10	1.25G	SFP	1310/1550	10KM	-9~-3	0~70	<-22	LC	FP+PIN
ESB5312-3LCD10	1.25G	SFP	1550/1310	10KM	-9~-3	0~70	<-22	LC	DFB+PIN
ESB3512-3LCD20	1.25G	SFP	1310/1550	20KM	-9~-3	0~70	<-22	LC	FP+PIN
ESB5312-3LCD20	1.25G	SFP	1550/1310	20KM	-9~-3	0~70	<-22	LC	DFB+PIN
ESB3412-3LCD20	1.25G	SFP	1310/1490	20KM	-9~-3	0~70	<-22	LC	FP+PIN
ESB4312-3LCD20	1.25G	SFP	1490/1310	20KM	-9~-3	0~70	<-22	LC	DFB+PIN
ESB3512-3LCD40	1.25G	SFP	1310/1550	40KM	-5~0	0~70	<-24	LC	DFB+PIN
ESB5312-3LCD40	1.25G	SFP	1550/1310	40KM	-5~0	0~70	<-24	LC	DFB+PIN
ESB3412-3LCD40	1.25G	SFP	1310/1490	40KM	-5~0	0~70	<-24	LC	DFB+PIN
ESB4312-3LCD40	1.25G	SFP	1490/1310	40KM	-5~0	0~70	<-24	LC	DFB+PIN
ESB3512-3LCD60	1.25G	SFP	1310/1550	60KM	0~5	0~70	<-26	LC	DFB+PIN
ESB5312-3LCD60	1.25G	SFP	1550/1310	60KM	0~5	0~70	<-26	LC	DFB+PIN
ESB5412-3LCD80	1.25G	SFP	1550/1490	80KM	0~5	0~70	<-26	LC	DFB+PIN
ESB4512-3LCD80	1.25G	SFP	1490/1550	80KM	0~5	0~70	<-26	LC	DFB+PIN
ESB5412-3LCD120	1.25G	SFP	1550/1490	120KM	1~5	0~70	<-32	LC	DFB+APD
ESB4512-3LCD120	1.25G	SFP	1490/1550	120KM	1~5	0~70	<-32	LC	DFB+APD
ESB5412-3LCD160	1.25G	SFP	1550/1490	160KM	1~6	0~70	<-33	LC	DFB+APD
ESB4512-3LCD160	1.25G	SFP	1490/1550	160KM	1~6	0~70	<-33	LC	DFB+APD
ESB3512-3SCD3	1.25G	SFP	1310/1550	3KM	-10~-4	0~70	<-20	SC	FP+PIN
ESB5312-3SCD3	1.25G	SFP	1550/1310	3KM	-10~-4	0~70	<-20	SC	FP+PIN
ESB3512-3SCD20	1.25G	SFP	1310/1550	20KM	-9~-3	0~70	<-22	SC	FP+PIN
ESB5312-3SCD20	1.25G	SFP	1550/1310	20KM	-9~-3	0~70	<-22	SC	DFB+PIN
ESB3512-3SCD40	1.25G	SFP	1310/1550	40KM	-5~0	0~70	<-24	SC	DFB+PIN
ESB5312-3SCD40	1.25G	SFP	1550/1310	40KM	-5~0	0~70	<-24	SC	DFB+PIN
ESB4512-3SCD80	1.25G	SFP	1490/1550	80KM	0~5	0~70	<-26	SC	DFB+PIN
ESB5412-3SCD80	1.25G	SFP	1550/1490	80KM	0~5	0~70	<-26	SC	DFB+PIN

1.25G SFP Single Fiber Transceiver

Applications 23:

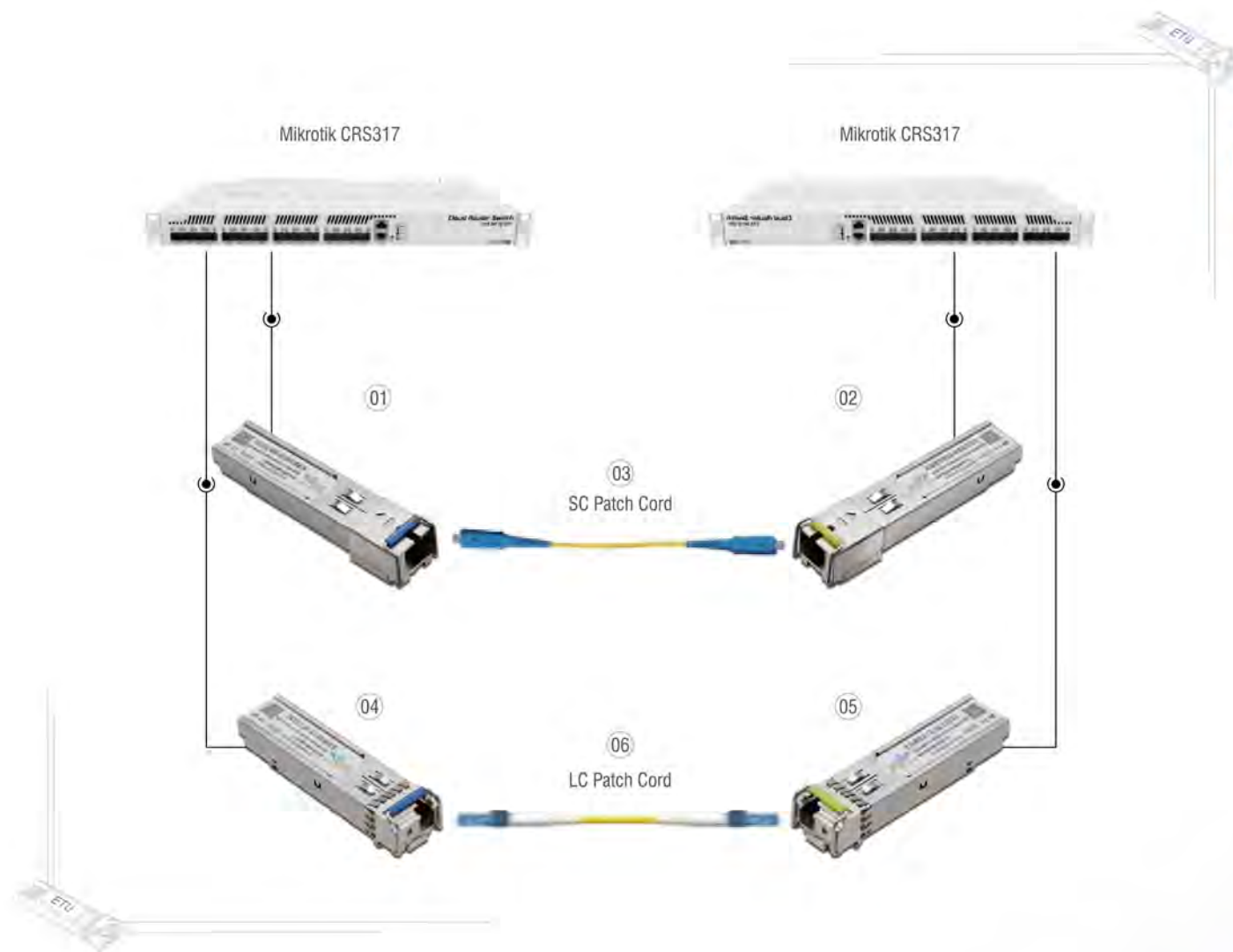

Item No	ETU PN	Description
01	ESB3512-3SCD3	1.25G BIDI TX1310nm RX1550nm SC 3KM DDM
02	ESB5312-3SCD3	1.25G BIDI TX1550nm RX1310nm SC 3KM DDM
03	Patch Cord	SC/UPC-SC/UPC SM SX OS2
04	ESB3512-3LCD3	1.25G BIDI TX1310nm RX1550nm LC 3KM DDM
05	ESB5312-3LCD3	1.25G BIDI TX1550nm RX1310nm LC 3KM DDM
06	Patch Cord	LC/UPC-LC/UPC SM SX OS2

1.25G SFP Dual Fiber Transceiver



Features

- Compliant with specifications for IEEE802.3Z
- Multi-source package with duplex LC connector
- Eye safety designed to meet laser class1
- Compliant with IEC60825-1
- Single +3.3V power supply
- Hot pluggable
- Monitoring interface compliant with SFF-8472
- Compliant with bellcore TA-NWT-000983

1.25G & 2.5G CWDM SFP Transceiver



Features

- Data-rate of 1.25Gbps/2.67Gbps operation
- Up to 120km on 9/125μm SMF
- Standard serial ID information compliant with SFP MSA
- SFP MSA package with duplex LC connector
- Digital diagnostic monitor interface
- +3.3V single power supply
- Wide operating temperature range
- ROHS compliant

Product Information

Model No.	Data Rate	Package	Wavelength(nm)	Distance	Output Power	Temp.(°C)	Sensitivity	Interface	Source
ES8512-3LCD05	1.25G	SFP	850	550M	-10~-4	0~70	<-18	LC	VCSEL+PIN
ES3112-3LCD2	1.25G	SFP	1310	2KM	-10~-4	0~70	<-20	LC	FP+PIN
ES3112-3LCD10	1.25G	SFP	1310	10KM	-9~-3	0~70	<-22	LC	FP+PIN
ES3112-3LCD20	1.25G	SFP	1310	20KM	-9~-3	0~70	<-22	LC	FP+PIN
ES3112-3LCD40	1.25G	SFP	1310	40KM	-5~0	0~70	<-24	LC	DFB+PIN
ES5512-3LCD40	1.25G	SFP	1550	40KM	-5~0	0~70	<-24	LC	DFB+PIN
ES5512-3LCD80	1.25G	SFP	1550	80KM	0~5	0~70	<-26	LC	DFB+PIN
ES5512-3LCD120	1.25G	SFP	1550	120KM	1~5	0~70	<-32	LC	DFB+APD
ES5512-3LCD160	1.25G	SFP	1550	160KM	0~5	0~70	<-34	LC	DFB+APD

Product Information

Model No.	Data Rate	Package	Wavelength(nm)	Distance	Output Power	Temp.(°C)	Sensitivity	Interface	Source
ESCxx12-3LCD40	1.25G	SFP	1270~1450	40KM	-5~0	0~70	<-24	LC	CWDM+PIN
ESCxx12-3LCD80	1.25G	SFP	1470~1610	80KM	0~5	0~70	<-26	LC	CWDM+PIN
ESCxx12-3LCD120	1.25G	SFP	1470~1610	120KM	1~5	0~70	<-32	LC	CWDM+APD
ESCxx24-3LCD40	2.5G	SFP	1470~1610	40KM	-5~0	0~70	<-24	LC	CWDM+PIN
ESCxx24-3LCD80	2.5G	SFP	1470~1610	80KM	0~5	0~70	<-26	LC	CWDM+APD

155M SFP Single Fiber Transceiver



Features

- Up to 155Mbps data-rate
- Compliant with SFP MSA and SFF-8472 with simplex LC receptacle
- Digital diagnostic monitoring: internal calibration or external calibration
- Compatible with ROHS
- +3.3V single power supply
- Commercial case temperature range: 0°C to 70°C

Product Information

Model No.	Data Rate	Package	Wavelength(nm)	Distance	Output Power	Temp.(°C)	Sensitivity	Interface	Source
ESB3503-3SCD3	155M	SFP	1310/1550	3KM	-14~-8	0~70	<-28	SC	FP+PIN
ESB5303-3SCD3	155M	SFP	1550/1310	3KM	-14~-8	0~70	<-28	SC	FP+PIN
ESB3503-3SCD20	155M	SFP	1310/1550	20KM	-14~-8	0~70	<-32	SC	FP+PIN
ESB5303-3SCD20	155M	SFP	1550/1310	20KM	-14~-8	0~70	<-32	SC	FP+PIN
ESB3503-3SCD40	155M	SFP	1310/1550	40KM	-5~0	0~70	<-32	SC	FP+PIN
ESB5303-3SCD40	155M	SFP	1550/1310	40KM	-5~0	0~70	<-32	SC	DFB+PIN
ESB4503-3SCD80	155M	SFP	1310/1550	80KM	-5~0	0~70	<-32	SC	DFB+PIN
ESB5403-3SCD80	155M	SFP	1550/1310	80KM	-5~0	0~70	<-32	SC	DFB+PIN
ESB3503-3LCD3	155M	SFP	1310/1550	3KM	-14~-8	0~70	<-28	LC	FP+PIN
ESB5303-3LCD3	155M	SFP	1550/1310	3KM	-14~-8	0~70	<-28	LC	FP+PIN
ESB3503-3LCD10	155M	SFP	1310/1550	10KM	-15~-8	0~70	<-32	LC	FP+PIN
ESB5303-3LCD10	155M	SFP	1550/1310	10KM	-15~-8	0~70	<-32	LC	FP+PIN
ESB3503-3LCD20	155M	SFP	1310/1550	20KM	-15~-8	0~70	<-32	LC	FP+PIN
ESB5303-3LCD20	155M	SFP	1550/1310	20KM	-15~-8	0~70	<-32	LC	FP+PIN
ESB3403-3LCD20	155M	SFP	1310/1490	20KM	-15~-8	0~70	<-32	LC	FP+PIN
ESB4303-3LCD20	155M	SFP	1490/1310	20KM	-15~-8	0~70	<-32	LC	DFB+PIN
ESB3503-3LCD40	155M	SFP	1310/1550	40KM	-5~0	0~70	<-32	LC	FP+PIN
ESB5303-3LCD40	155M	SFP	1550/1310	40KM	-5~0	0~70	<-32	LC	DFB+PIN
ESB3403-3LCD40	155M	SFP	1310/1490	40KM	-5~0	0~70	<-32	LC	FP+PIN
ESB4303-3LCD40	155M	SFP	1490/1310	40KM	-5~0	0~70	<-32	LC	DFB+PIN
ESB4503-3LCD80	155M	SFP	1490/1550	80KM	-5~0	0~70	<-32	LC	DFB+PIN
ESB5403-3LCD80	155M	SFP	1550/1490	80KM	-5~0	0~70	<-32	LC	DFB+PIN
ESB4503-3LCD120	155M	SFP	1490/1550	120KM	0~5	0~70	<-32	LC	DFB+APD
ESB5403-3LCD120	155M	SFP	1550/1490	120KM	0~5	0~70	<-32	LC	DFB+APD

155M SFP Dual Fiber Transceiver



Features

- Up to 155Mbps data-rate
- Compliant with SFP MSA and SFF-8472 with duplex LC receptacle
- Digital diagnostic monitoring: internal calibration or external calibration
- Compatible with ROHS
- +3.3V single power supply
- Commercial case temperature range: 0°C to 70°C

Product Information

Model No.	Data Rate	Package	Wavelength(nm)	Distance	Output Power	Temp.(°C)	Sensitivity	Interface	Source
ES3103-3LCD2	155M	SFP	1310	2KM	-20~-10	0~70	<-32	LC	FP+PIN
ES3103-3LCD20	155M	SFP	1310	20KM	-15~-8	0~70	<-32	LC	FP+PIN
ES3103-3LCD40	155M	SFP	1310	40KM	-5~0	0~70	<-32	LC	DFB+PIN
ES5503-3LCD80	155M	SFP	1550	80KM	-2~3	0~70	<-34	LC	DFB+PIN
ES5503-3LCD120	155M	SFP	1550	120KM	0~5	0~70	<-32	LC	DFB+PIN
ES5503-3LCD160	155M	SFP	1550	160KM	1~5	0~70	<-34	LC	DFB+APD

Applications 24:



Item No	ETU PN	Description
01	EM-100-SSXX	10/100M SFP Media Converter
02	ES3103-3LCD20	155M SFP LX 1310nm 20km

EPON/GPON Transceiver



Features

- ❖ Single fiber bi-directional data links symmetric 1.25Gbps application/ 2.488Gbps Tx and 1.244Gbps Rx
- ❖ ROHS 6 compliance
- ❖ 1490nm continuous-mode DFB laser transmitter and 1310nm burst-mode APD-TIA receiver
- ❖ Low EMI and excellent ESD protection

Coding Tool



Hardware:

- ❖ Name: Coding Box
- ❖ Interface Type: USB Type C (USB power supply)
- ❖ Work Voltage: +5V
- ❖ Maximum Power: 3.5W
- ❖ Support Module Type: SFP, SFP+, SFP28, SFP56, XFP, QSFP+, QSFP28, QSFP DD

Software:

- ❖ Software Name: Coding Box Software
- ❖ Operating Environment: Windows XP\7\8\8.1\10 32\64bit

Product Information

Model No.	Data Rate	Package	Wavelength(nm)	Distance	Output Power	Temp.(°C)	Interface	Source
EEP4311-3SCP2	1.25G/1.25G	EPON OLT PX20+	Tx 1490nm 1.25G, Rx 1310nm 1.25G	20KM	3.5~4.5	0~70	SC	DFB+APD
EEP4311-3SCP2x	1.25G/1.25G	EPON OLT PX20++	Tx 1490nm 1.25G, Rx 1310nm 1.25G	20KM	5.5~6.5	0~70	SC	DFB+APD
EEP4311-3SCP2xx	1.25G/1.25G	EPON OLT PX20+++ Enhanced (7db)	Tx 1490nm 1.25G, Rx 1310nm 1.25G	20KM	6~7	0~70	SC	DFB+APD
EEP3411-3SCP2	1.25G/1.25G	EPON ONU PX20+	Tx 1310nm 1.25G, Rx 1490nm 1.25G	20KM	0~4	0~70	SC	DFB+APD
EGP4321-3SCB2	2.5G/1.25G	GPON OLT B+	TX 1490nm 2.488Gbps, RX 1310nm 1.244Gbps	20KM	3~4	0~70	SC	DFB+APD
EGP4321-3SCC2	2.5G/1.25G	GPON OLT C+	TX 1490nm 2.488Gbps, RX 1310nm 1.244Gbps	20KM	4.5~5.5	0~70	SC	DFB+APD
EGP4321-3SCC2x	2.5G/1.25G	GPON OLT C++	TX 1490nm 2.488Gbps, RX 1310nm 1.244Gbps	20KM	5.5~6.5	0~70	SC	DFB+APD
EGP3412-3SCB2	1.25G/2.5G	GPON ONU B+	Tx 1310nm 1.25G, Rx 1490nm 2.488G	20KM	0.5~5	0~70	SC	DFB+APD

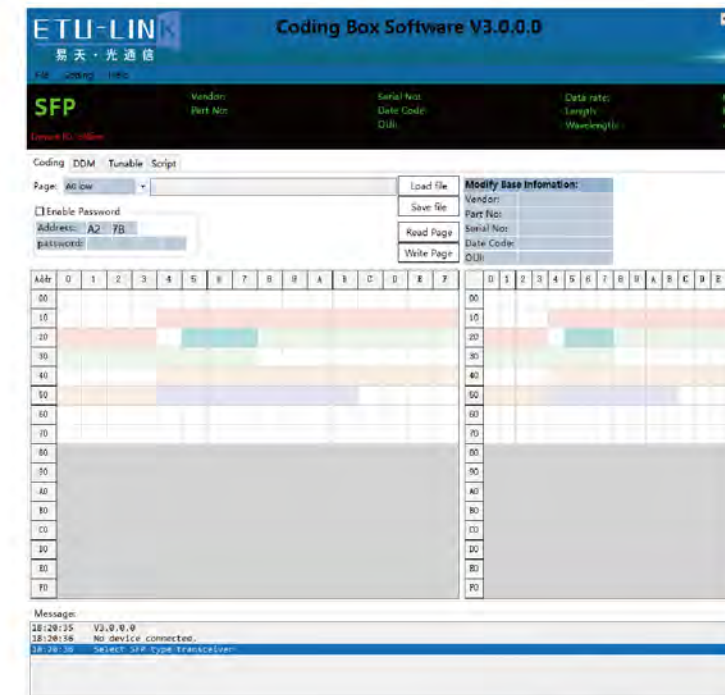

Patch Cord Details



Features

- Low insertion loss and back reflection loss
- Good durability
- Good exchange ability
- High temperature stability
- Standard: telcordia GR-326-CORE
- Compact design
- IEC,JIS,TELCORDIA-326 compliance



Features

- MPO connector complied with IEC-61754-7 A quick-to-deploy
- Scalable solution
- High compatibility, flexibility & system
- Performance lower installation cost
- Optimized performance - Elite MPO and discrete premium connector
- Support 40GBASE-SR4 in applicable parallel optics networks
- Compliant to IEC-61754-7 and TIA-604-5(FOCIS-5) standard

Application

- SAN (Storage Area Network) data center LAN
- LAN/SAN switch equipment distribution
- Area(EDA) emerging 40G and 100G protocols

Patch Cord Order Information

Connector-1	Polishing	Connector-2	Polishing	Cable Type	Length	Cable Diamete	Fiber Cont	Remark
SC	APC	LC	PC	OS2	5M	2.0MM	Duplex	LSZH
FC,SC	PC,UPC	FC,SC	PC,UPC	OM1 62.5/125	0.5M	0.9MM	Simplex	Colors
LC,ST	APC	LC,ST	APC	OM2 50/125	1M,2M	1.8MM	Duplex	Armored
MU,MTRJ		MU,MTRJ	DIN	OM3 (10G)	3M,4M	2.0MM	4,6,8 Counts	Waterproof
E2000,MPO		E2000,MPO		OS1	5M...	3.0MM	12 Counts...	LSZH
SMA,DIN		SMA,DIN		OS2 9/12	100M...	Others	48 Counts...	PVC
				G657A/B/D	500M...			OFNR
				G655	1000M...			OFNP

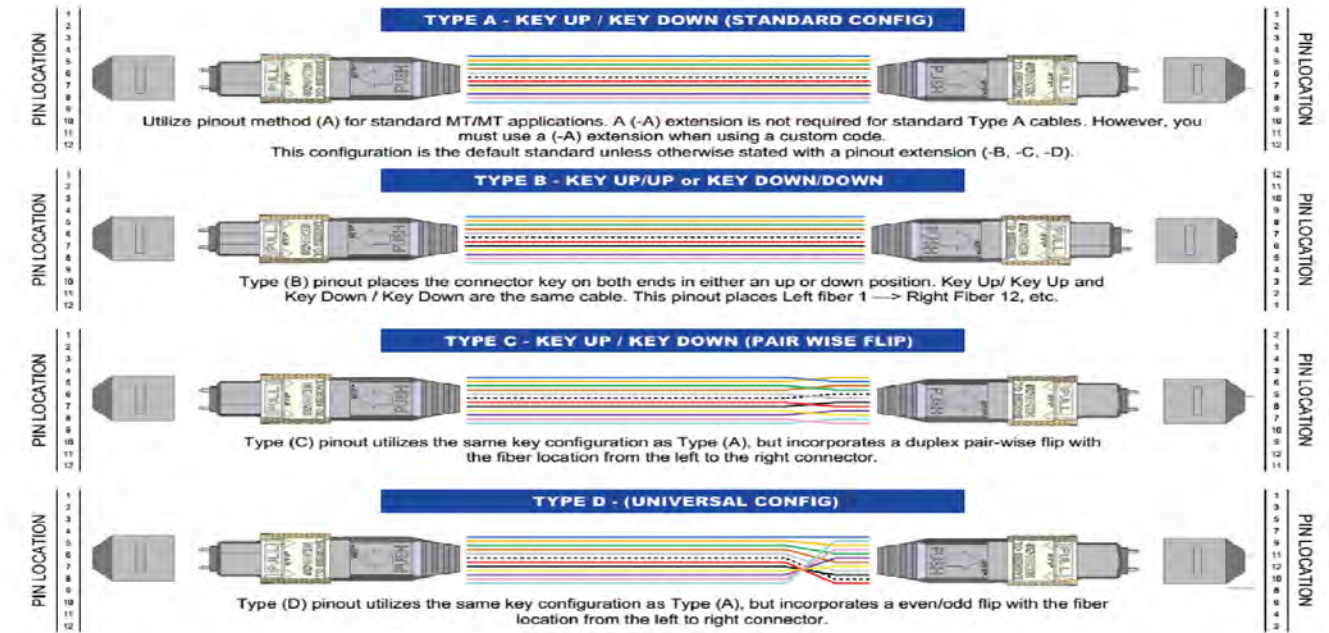

Pigtail Details



Features

- Insert loss ≤ 0.2dB
- Return loss: PC/UPC > 35dB APC > 60dB
- Temperature range: -40~+55°C
- 0.9mm, 2.0mm, 3.0mm

Pigtail Order Information

Connector-1	Polishing	Cable Type	Length	Cable Diamete	Fiber Cont	Remark
SC	APC	OS2	0.5M	0.9MM	Simplex	LSZH
FC,SC	PC,UPC	OM1 62.5/125	0.5M	0.9MM	Simplex	Colors
LC,ST	APC	OM2 50/125	1M,2M	1.8MM	4,6,8 Counts	Armored
MU,MTRJ		OM3 10G	3M	2.0MM	12 Counts...	Waterproof
E2000,MPO		OS1		3.0MM	48 Counts...	LSZH
SMA,DIN		OS2 9/125		Others		PVC
		G657A1/2/G652D				OFNR

Adapter Details



Features

- ❖ Low insertion loss high return loss
- ❖ High-precision alignment
- ❖ Accord with the standard of the telcordia ANSI,-TIA/EIA,NTT,JIS
- ❖ Optional for the shell material or sleeve material
- ❖ Compatible with NTT-SC standard

Adapter Order Information

Connector-1	Polishing	Color	Material	Sleeve Material	Channels	Remark
SC		Blue	Material	Zirconia Ceramic	Simplex	Dust Cap Color
FC,SC		Blue	Plastic	Zirconia Ceramic	Simplex	Black
LC,ST	PC	Beige	Plastic	Phosphor Bronze	Duplex	Red
MU,MTRJ	PC,UPC	Green	Metal			Blue
E2000	APC					Beige
						Green

Applications 25:



10G SFP Media Converter without SFP Module



Features

- ❖ 10G SFP+ to UTP
- ❖ Transparent Transport and very low delay
- ❖ Up to 100km
- ❖ External power
- ❖ supply Support Loopback test function
- ❖ Economic In-band Management function
- ❖ Support hot plugging
- ❖ Support 2U Rack (16 channel) and standalone use
- ❖ Full State Led display
- ❖ UTP cable length detection(only RJ45 interface)

Applications 26:



Cisco N9K-C9348GC-FXP

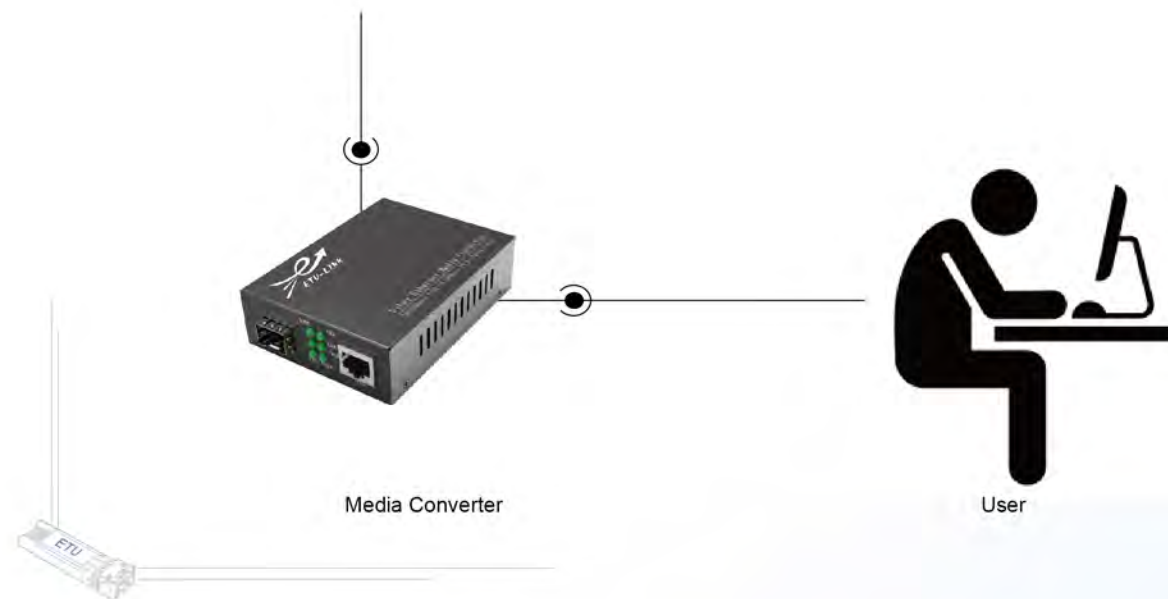

Item No	ETU PN	Description
01	EM-10000-SSXX	10G SFP+ Media Converter without SFP Module

Media Converter



Features

- ❖ This product supports IEEE802.3 10 base-T
- ❖ Standard/IEEE 802.3u 100Base-TX/FX
- ❖ Standard/IEEE 802.3z 1000Base-TX/FX standard, as well as full duplex and half duplex mode.

Media Converter	
Model	Description
10/100Mbps Dual Fiber	
EM-100-M2	10/100M Dual Fiber MM Media Converter,1310nm,2KM SC Connector
EM-100-S20	10/100M Dual Fiber SM Media Converter,1310nm,20KM SC Connector
EM-100-S40	10/100M Dual Fiber SM Media Converter,1310nm,40KM SC Connector
EM-100-S60	10/100M Dual Fiber SM Media Converter,1550nm,60KM SC Connector
EM-100-S80	10/100M Dual Fiber SM Media Converter,1550nm,80KM SC Connector
10/100Mbps Single Fiber	
EM-100-BS20	10/100M Single Fiber SM Media Converter,1310/1550nm,20KM SC Connector 10/100M Single Fiber SM Media Converter,1550/1310nm,20KM SC Connector
EM-100-BS40	10/100M Single Fiber SM Media Converter,1310/1550nm,40KM SC Connector 10/100M Single Fiber SM Media Converter,1550/1310nm,40KM SC Connector
EM-100-BS60	10/100M Single Fiber SM Media Converter,1490/1550nm,60KM SC Connector 10/100M Single Fiber SM Media Converter,1550/1490nm,60KM SC Connector
EM-100-BS80	10/100M Single Fiber SM Media Converter,1490/1550nm,80KM SC Connector 10/100M Single Fiber SM Media Converter,1550/1490nm,80KM SC Connector
1000Mbps Dual Fiber	
EM-1000-M05	1000M Dual Fiber MM Media Converter,850nm 550M SC Connector
EM-1000-S20	1000M Dual Fiber SM Media Converter,1310nm,20KM SC Connector
1000Mbps Single Fiber	
EM-1000-BS20	1000M Single Fiber SM Media Converter,1310/1550nm,20KM SC Connector 1000M Single Fiber SM Media Converter,1550/1310nm,20KM SC Connector

Media Converter

10/100/1000Mbps Dual Fiber	
EM-1100-M05	10/100/1000M Dual Fiber MM Media Converter,850nm,550M SC Connector
EM-1100-M2	10/100/1000M Dual Fiber MM Media Converter,1310nm,2KM SC Connector
EM-1100-S20	10/100/1000M Dual Fiber SM Media Converter,1310nm,20KM SC Connector
EM-1100-S40	10/100/1000M Dual Fiber SM Media Converter,1310nm,40KM SC Connector
EM-1100-S60	10/100/1000M Dual Fiber SM Media Converter,1550nm,60KM SC Connector
EM-1100-S80	10/100/1000M Dual Fiber SM Media Converter,1550nm,80KM SC Connector
10/100/1000Mbps Single Fiber	
EM-1100-BS20	10/100/1000M Single Fiber SM Media Converter,1310/1550nm,20KM SC Connector 10/100/1000M Single Fiber SM Media Converter,1550/1310nm,20KM SC Connector
EM-1100-BS40	10/100/1000M Single Fiber SM Media Converter,1310/1550nm,40KM SC Connector 10/100/1000M Single Fiber SM Media Converter,1550/1310nm,40KM SC Connector
EM-1100-BS60	10/100/1000M Single Fiber SM Media Converter,1490/1550nm,60KM SC Connector 10/100/1000M Single Fiber SM Media Converter,1550/1490nm,60KM SC Connector
SFP Media Converter	
EM-100-SSXX	10/100Mbps SFP Media Converter without SFP Module
EM-1100-SSXX	10/100/1000Mbps SFP Media Converter without SFP Module
10G SFP+ Media Converter	
EM-11100-SSXX	10G SFP+ Media Converter without SFP Module

Applications 27:

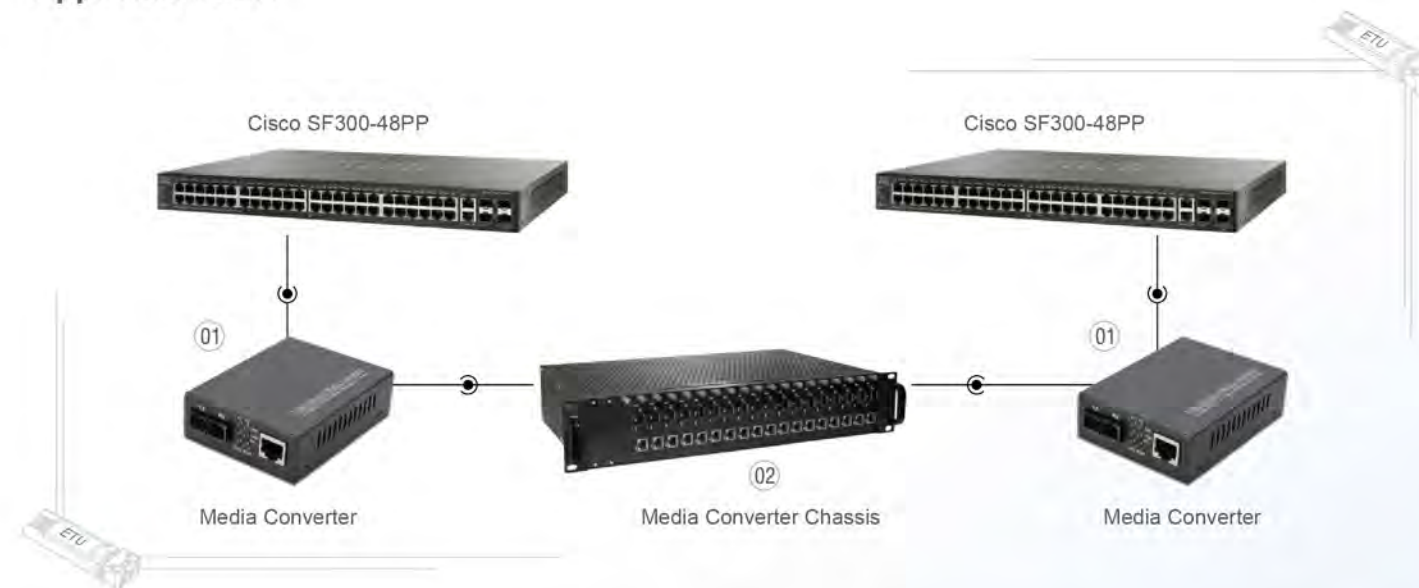

Item No	ETU PN	Description
01	EM-1100-S20	10/100/1000M Media Converter 1310nm 20km
02	Media Converter Chassis	Media Converter Chassis

Regular Product

Abbreviation	ETU PN	Description
RJ45	ES-T2-R	10/100/1000M SFP Copper-T RJ45 100M
10G RJ45	ES-T5-R	10G SFP+ Copper-T RJ45 30M
SX	ES8512-3LCD05	1.25G SFP 850nm 550M LC DDM
LX	ES3112-3LCD10	1.25G SFP 1310nm 10KM LC DDM
	ES3112-3LCD20	1.25G SFP 1310nm 20KM LC DDM
EX	ES3112-3LCD40	1.25G SFP 1310nm 40KM LC DDM
	ES5512-3LCD40	1.25G SFP 1550nm 40KM LC DDM
ZX	ES5512-3LCD80	1.25G SFP 1550nm 80KM LC DDM
SR	ES85X-3LCD03	10G SFP+ 850nm 300M LC DDM
LR	ES31X-3LCD10	10G SFP+ 1310nm 10KM LC DDM
	ES31X-3LCD20	10G SFP+ 1310nm 20KM LC DDM
ER	ES31X-3LCD40	10G SFP+ 1310nm 40KM LC DDM
	ES55X-3LCD40	10G SFP+ 1550nm 40KM LC DDM
ZR	ES55X-3LCD80	10G SFP+ 1550nm 80KM LC DDM
QSFP+ SR4	EQ854X-3MCD01	40G QSFP+ 850nm 100M MPO DDM
QSFP+ LR4	EQ314X-3LCD10	40G QSFP+ 1310nm 10KM LC DDM
QSFP+ ER4	EQ314X-3LCD40	40G QSFP+ 1310nm 40KM LC DDM
QSFP+ ZR4	EQ314X-3LCD80	40G QSFP+ 1310nm 80KM LC DDM
QSFP28 SR4	EQ28510X-3MCD01	100G QSFP28 850nm 100M MPO DDM
QSFP28 LR4	EQ23110X-3LCD10	100G QSFP28 1310nm 10KM LC DDM
QSFP28 ER4	EQ23110X-3LCD40	100G QSFP28 1310nm 40KM LC DDM
QSFP28 ZR4	EQ23110X-3LCD80	100G QSFP28 1310nm 80KM LC DDM

Proper Nouns

SM:	Single Mode	MM:	Multimode
SX:	Simplex	DX:	Duplex
IL:	Insertion Loss	RL:	Return Loss
MSA:	Multi-Source Agreements	CDR:	Clock Data Recovery
DDM:	Digital Diagnostic Monitoring	WDM:	Wavelength Division Multiplexing
CWDM:	Coarse Wavelength Division Multiplexer	DWDM:	Dense Wavelength Division Multiplexer

Product Accessories



SR:



LR:



BD SC:



1.25G Dual Fiber :



10G BD:



1.25G BD:



Regular Product

